

PLEASE READ this sheet prior to assembly to familiarise yourself with the various stages of construction. Carefully open the pack supplied and check the contents against the parts and fittings check list.

Do not destroy any of the packaging until you are certain that you have all the necessary parts for the assembly.

Please ensure that the packaging is disposed of in a safe environmentally friendly way.

CAUTION: There are small components used in the construction of this unit. These loose items should be kept away from young children during assembly, to avoid the danger of choking.

IMPORTANT: BEFORE STARTING TO ASSEMBLE THE BED - PLEASE READ THESE INSTRUCTIONS CAREFULLY.

### Parts Identification

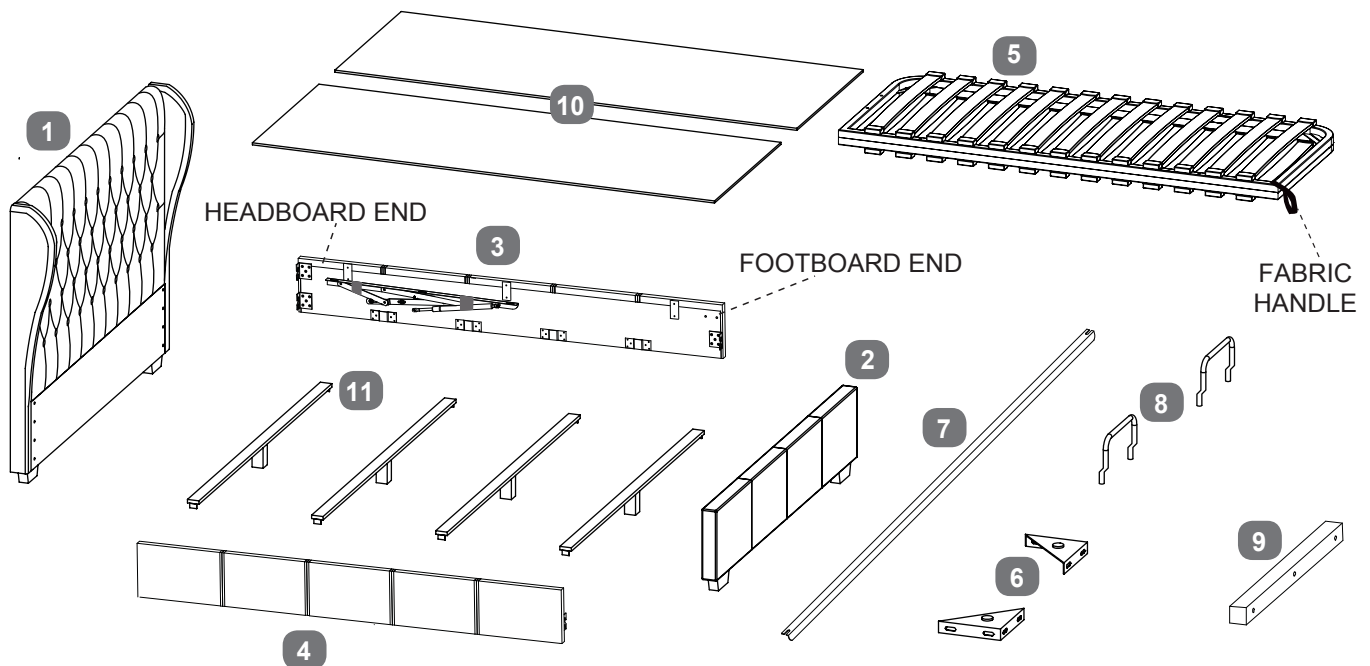

### Parts Checklist

Ref.	Description	Qty
1	Headboard	1
2	Footboard	1
3	Side Panel - Left	1
4	Side Panel - Right	1
5	Metal Slat Frame	1
6	Angle Brackets	2

Ref.	Description	Qty
7	Cross Bar	1
8	Mattress Stoppers	2
9	Slat Frame Support Rail (wood)	1
10	Base Boards	2
11	Base Board Support Rails (wood)	4

## Fittings Checklist

### HARDWARE NEEDED FOR BED ASSEMBLY (PACK A)

Code	Description	Qty	Code	Description	Qty
A	Bolts (M8x30mm) for fitting side panels (3&4) and to headboard & footboard (1&2)	x20	D	Allen Key (for M8 bolt)	x1
B	Spring Washers (for M8 bolts)	x20	E	Screws (5x50mm) for fitting wooden support rail (9) to footboard (2)	x3
C	Flat Washers (for M8 bolts)	x20			

### HARDWARE FOR FITTING METAL SLAT FRAME (PACK B)

Code	Description	Qty	Code	Description	Qty
B	Spring Washers (for M8 bolts)	x6	H	Flange Lock-Nuts (M8) for gas-lift pistons	x2
C	Flat Washers (for M8 bolts)	x16	I	Spanner (for M8 nut)	x1
F	Bolts (M8x50mm) for fitting Metal Slat Frame (5) to slat frame support bars	x6	J	Bolts (M8x20mm) for fitting Metal Plates (K) to Metal Slat Frame (5)	x4
G	Nuts (for M8 slat frame bolts)	x6	K	Metal Plates (for M8 bolts)	x2

### Additional Tools Required

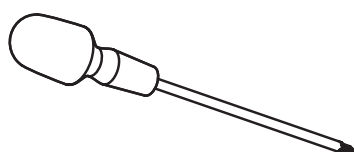

Cross-head Screwdriver

### Care & Maintenance

In the unlikely event of missing or damaged parts, please contact the customer service team on 0344 292 00 00. When calling this number, please quote the part code reference numbers shown in this leaflet when requesting spare or replacement parts.

### General Hints & Tips



Please retain your assembly instruction and tools provided for future use. Periodically check that all bolts are still tight.



This assembly requires two persons.



1 HOUR

Approximate time to assemble this product

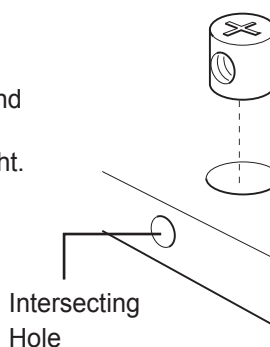

When they are supplied and are part of the assembly of this bed, ensure that the barrel nuts are fitted the correct way so the hole in the nut is facing towards the intersecting hole in the panel.

We recommend the bed is assembled in the room it shall be located in.

## Bed Assembly - Use Pack 'A'

Stage  
1

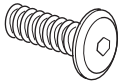
A  x12

B  x12

C  x12

D  x1

Fit two sets of bolts (A), spring washers (B), and flat washers (C) to the holes in the headboard (1) as shown.

**Note:** Do not tighten fully but leave 10mm protruding as in the diagram.

Fit the side panels (3 & 4) to the headboard locating the brackets behind the flat washers.

Fit the other two sets of bolts through the brackets into the central set of holes.

Tighten them all but loosely for now.

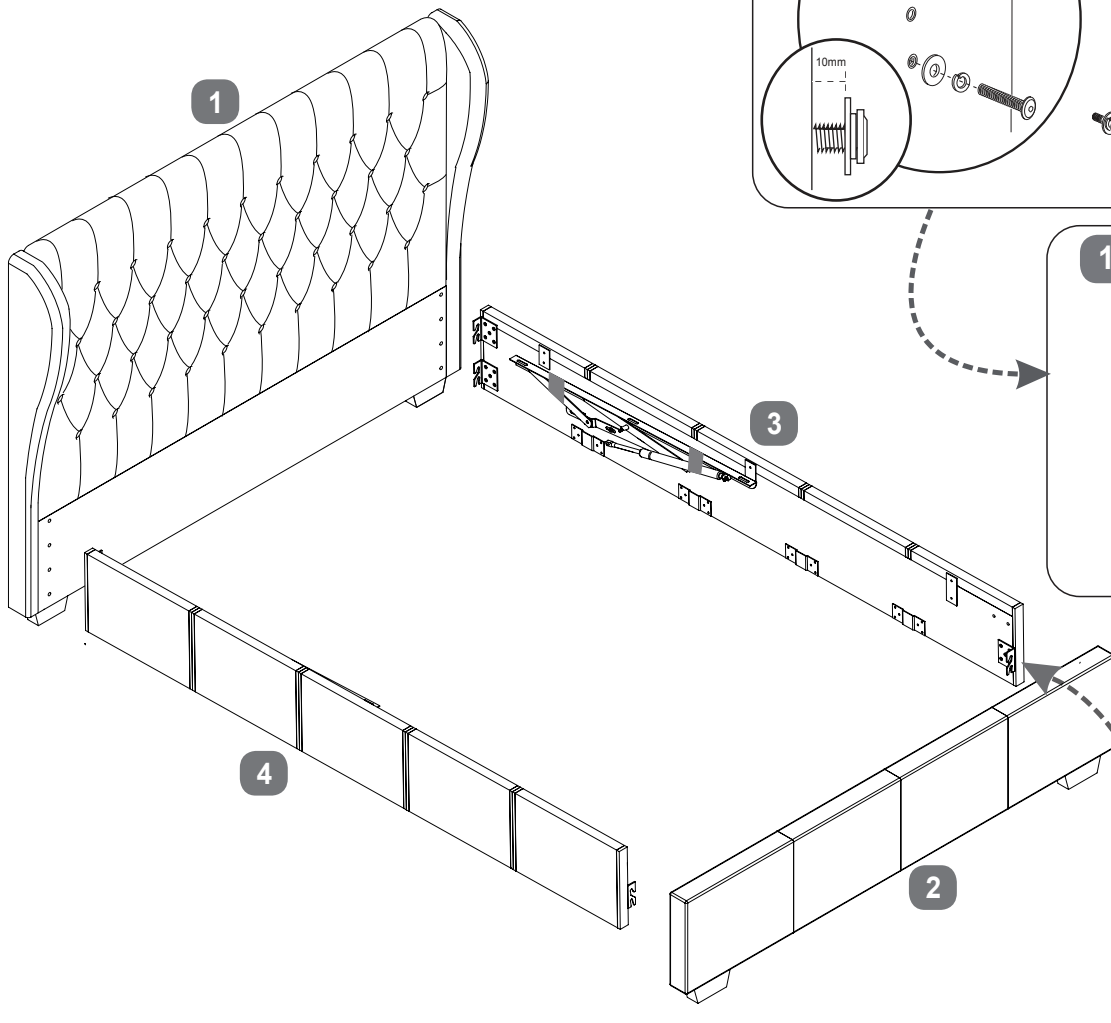
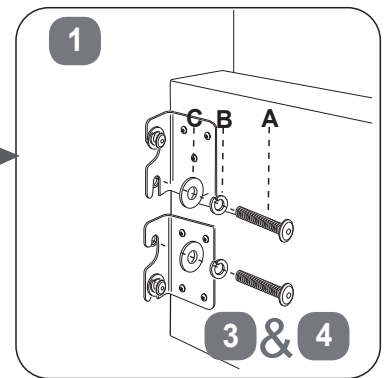
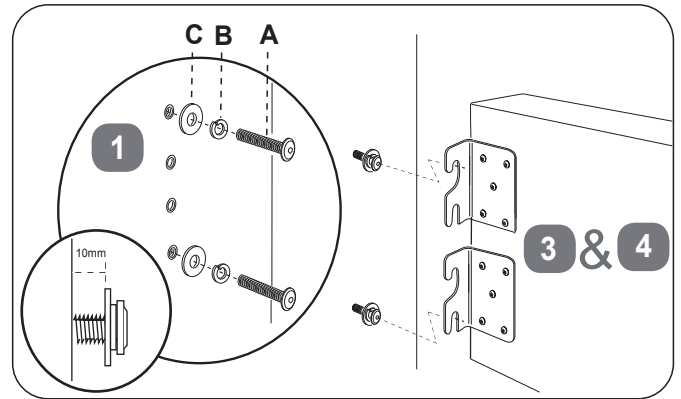

Fit two sets of bolts (A), spring washers (B), and flat washers (C) to the holes in the footboard (2) as shown.

**Note:** Do not tighten fully but leave 10mm protruding as in the diagram.

Fit the side panels (3 & 4) to the footboard locating the brackets behind the flat washers.

Tighten them all loosely for now.

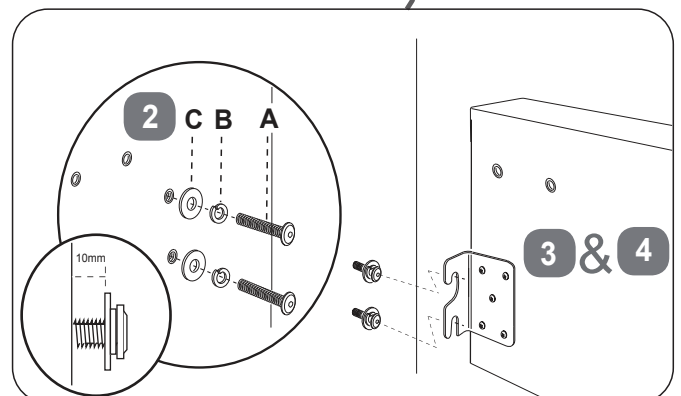

**PLEASE DO NOT TIGHTEN ANY BOLTS YET.**

## Bed Assembly - Use Pack 'A'

### Stage 2



- iv) Square up the bed to 90 degrees - then using sets of bolts (A), spring washers (B) & flat washers (C) fit angle brackets (6) into threaded inserts in the corners of footboard (2) & the side panels (3&4).

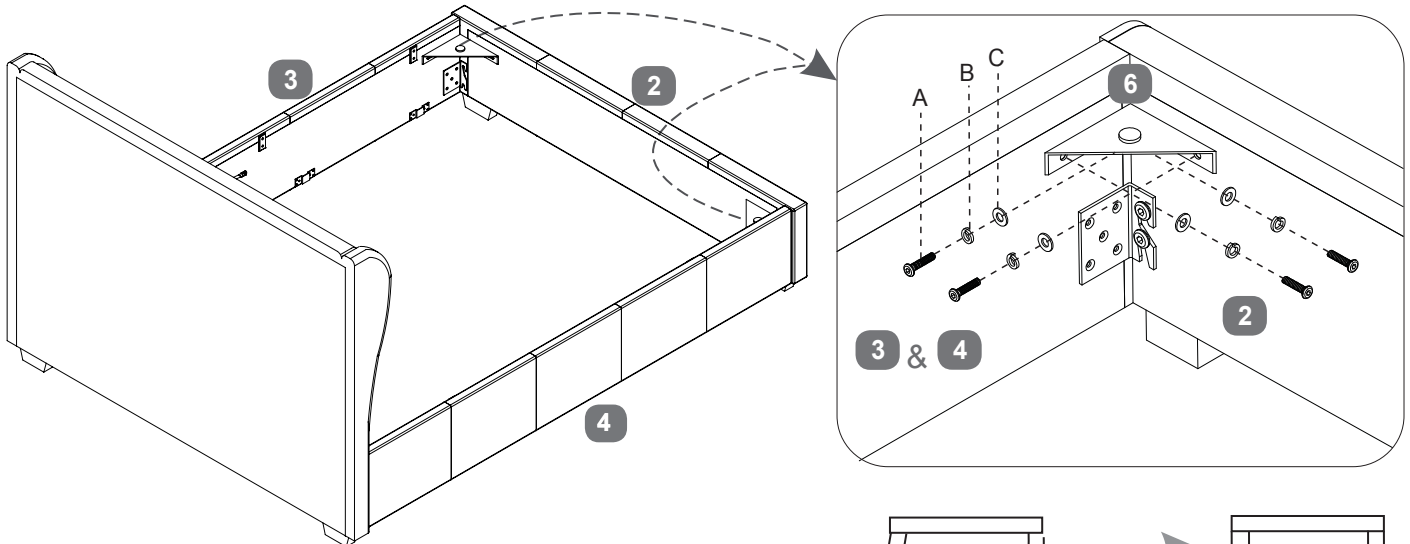

- v) MAKE CERTAIN THE BED IS SQUARED UP, AS SHOWN IN THE DIAGRAM .

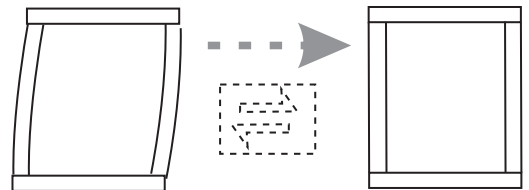

- vi) Once all four corners are located tighten all the bolts using the Allen key (D).

### Stage 3

Fix the base board support rails (11) to both side panels.  
**IMPORTANT:** Be careful not to scratch the leather or fabric when slotting the wooden supports into the side panel brackets.

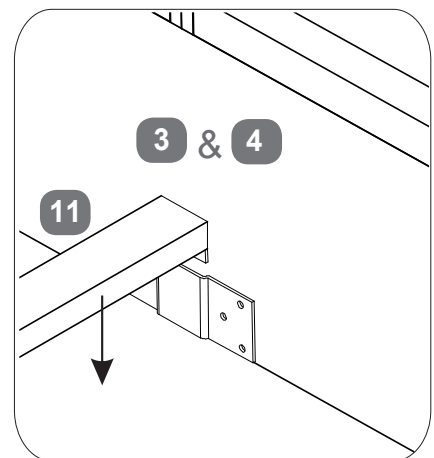
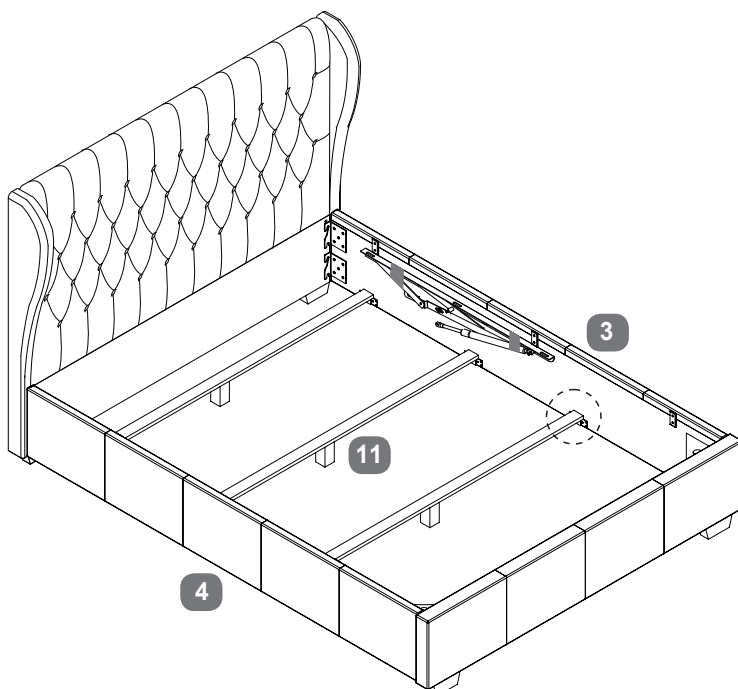

## Fit base boards - Use Pack 'A'

Stage

4

E  x3

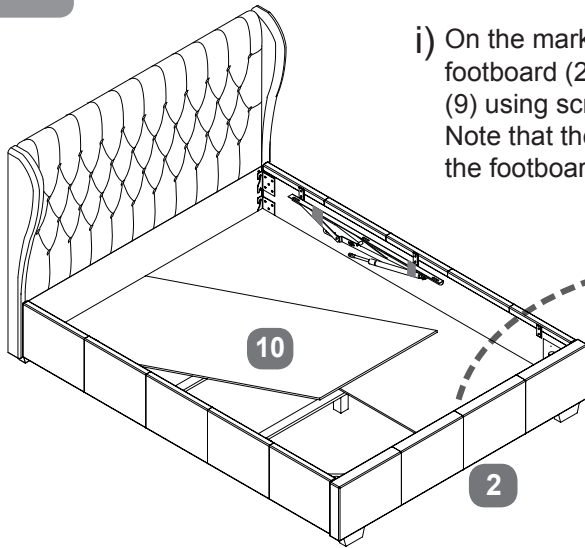

- i) On the marked line in the centre of the footboard (2), fix slat frame support rail (9) using screws (E). Note that the screws drive straight into the footboard, there are no pilot holes.

- ii) Carefully fit Base Boards (10).

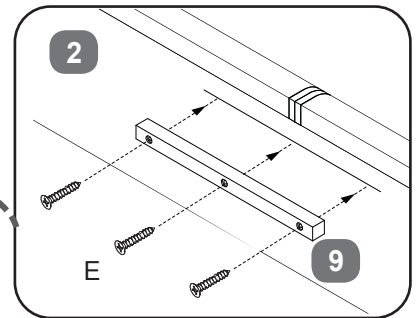

## Fitting Slat Frame - Use Pack 'B'

Stage

5

C  x4

D  x1

J  x4

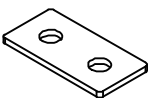
K  x2

- i) Open Metal Slat frame (5).

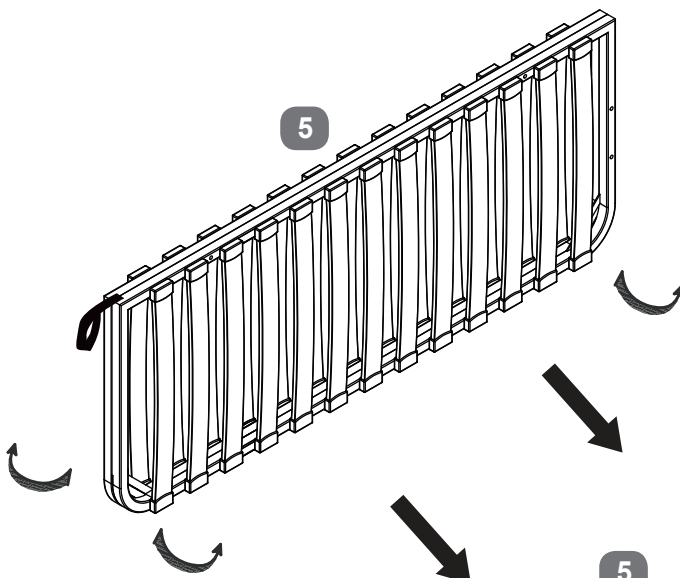

- ii) Using four sets of bolts (J) & flat washers (C) fit two pieces of the metal plate (K) into threaded insert on top of the Slat frame (5). Using Allen key (D), tighten them 100%.

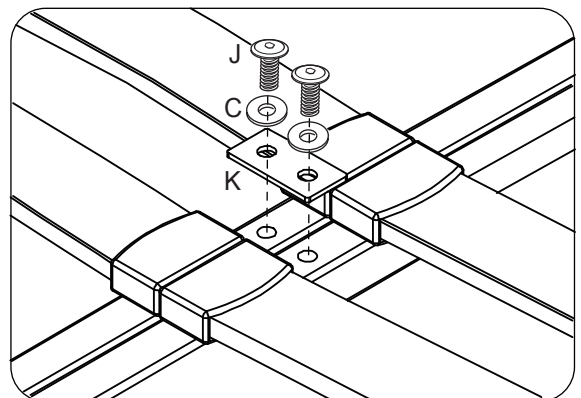

x2

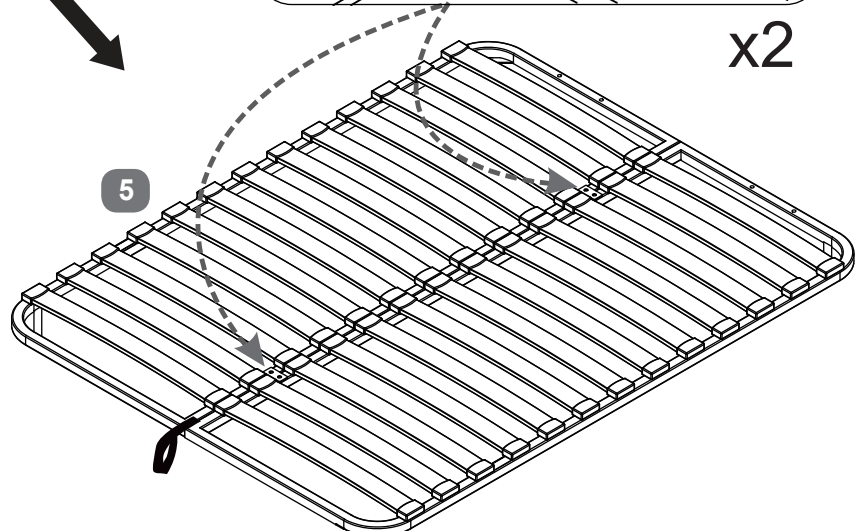

## Fitting Slat Frame - Use Pack 'B'

Stage  
6

B  x4

C  x8

D  x1

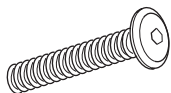
F  x4

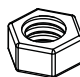
G  x4

I  x1

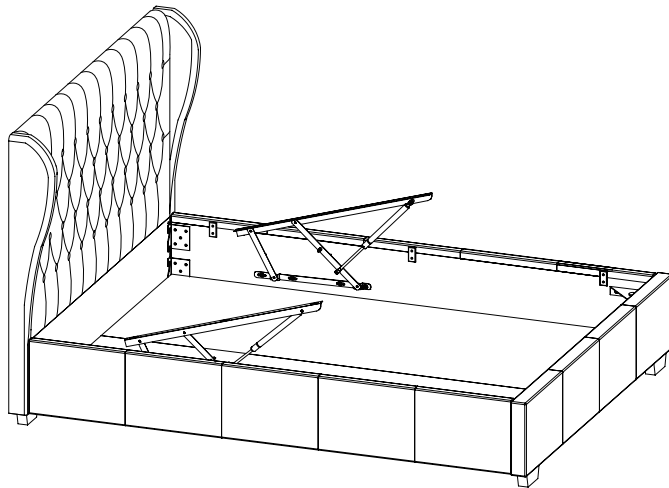

i) UN-TIE THE TWO MECHANISMS

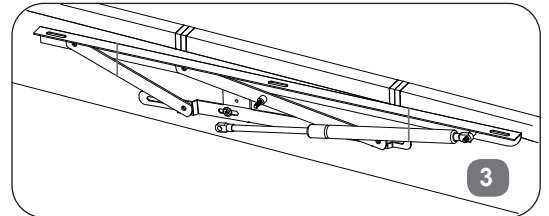

ii) HOLD THEM FORWARD

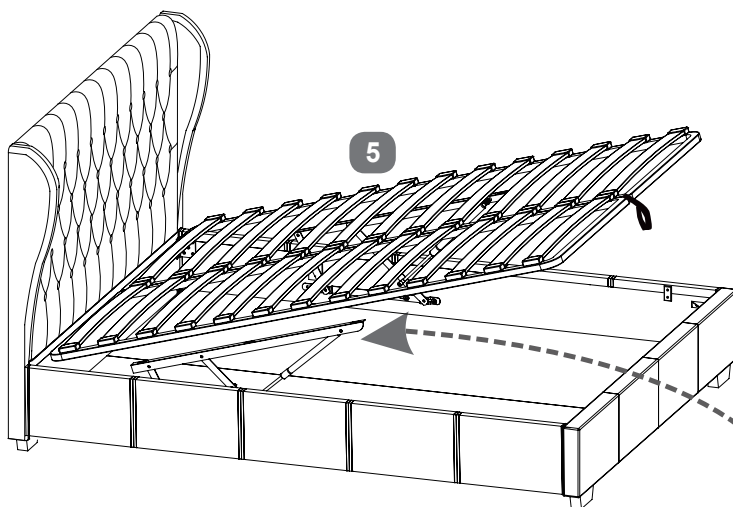
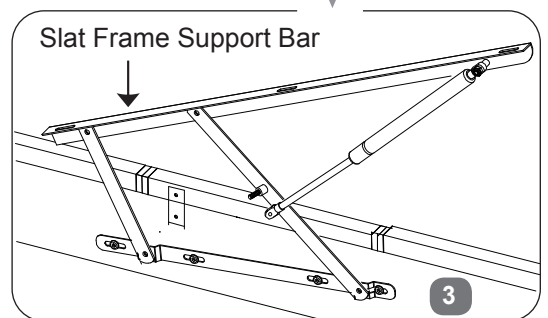

iii) With help from your assistant, lift slat frame (5) onto slat frame support bars aligning labeled holes on slat frame with first set of holes in support bars (nearest to headboard).

iv) Using two bolt sets on each side, (F),(C), (B) & (G), loosely fix slat frame to the other four holes - finger tight.

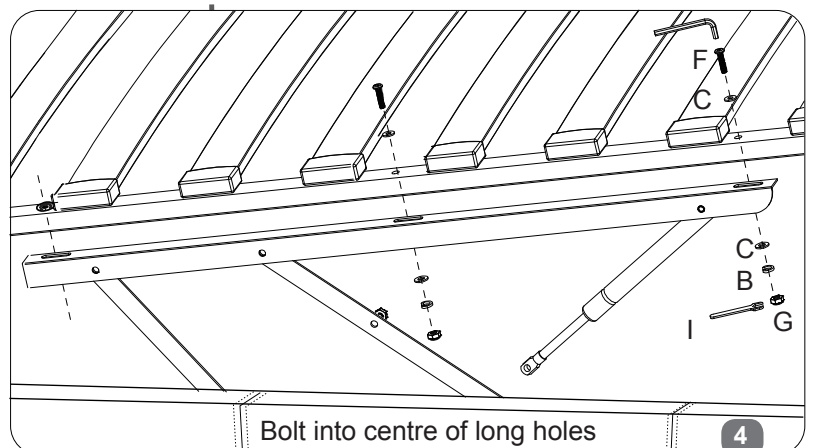

Bolt into centre of long holes

4



## Fitting Cross Bar - Use Pack 'B'

Stage

7

B  x2

C  x4

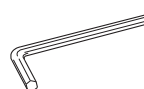
D  x1

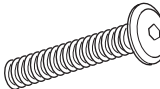
F  x2

G  x2

I  x1

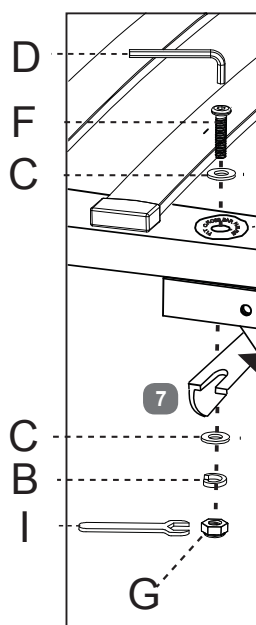
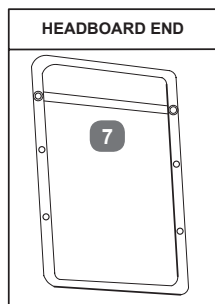

LABEL



CROSS BAR FITS HERE

Carefully hold cross bar (7) in position under the first set of holes in the support bars.

The holes to use for cross bar are clearly labeled - look carefully at the drawing. Note that the cross bar must be fitted in this position otherwise the gas lift cylinders will be damaged.

Using last two bolt sets (F), (C), (B) & (G) loosely clamp cross bar to underside of the slat frame support bars.

**NOTE: IT IS VERY IMPORTANT THAT THIS CROSS-BAR IS FITTED TO MAINTAIN THE STRENGTH OF THE FRAME**

## Fitting Slat Frame - Use Pack 'B'

Stage

8

D  x1

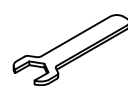
I  x1

Carefully lay frame down. Make sure there is an even gap each side of about 10mm, as in the sketch.

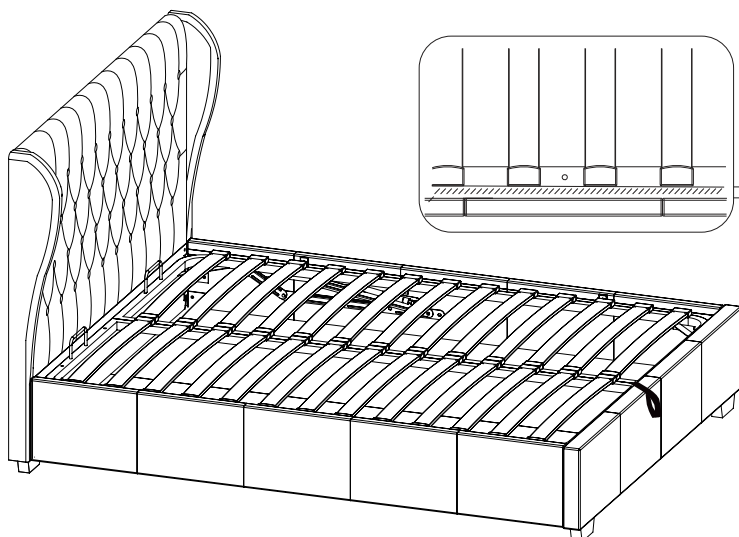

10mm

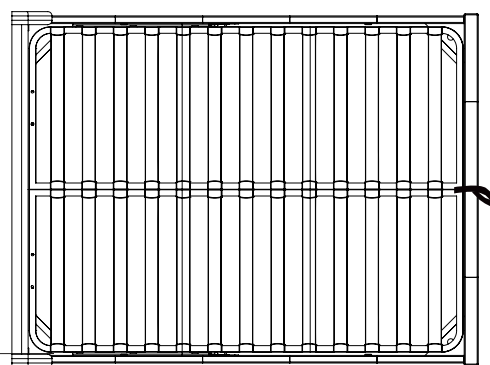

Hold frame then tighten all six bolt sets 100% using spanner (I) & Allen key (D).

## Fitting Slat Frame - Use Pack 'B'

Stage

9

H  x2 I  x1

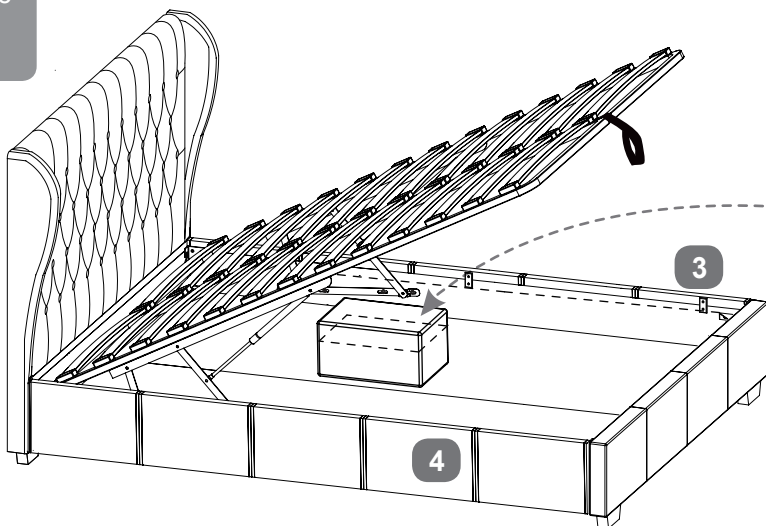

Note: Be very careful what you store under the bed - the top of an item, like a suitcase or a box, must not touch the slats or they shall be damaged. Maximum storage height is 185 mm.

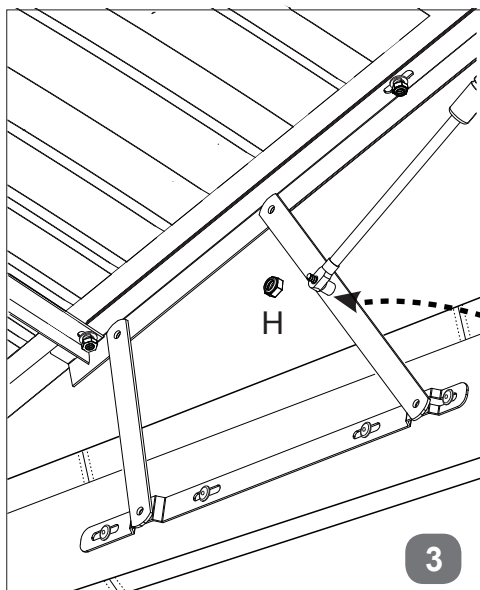

During this next step, the assistant should hold up the slat frame.

On side panels (3&4), slide gas-lift piston stems (X) onto the axles (Y) then fit the flange lock-nuts (H).

Tighten nuts with spanner (I) - DO NOT over-tighten. A small gap is left so stems can move freely - this is important - see sketch below.

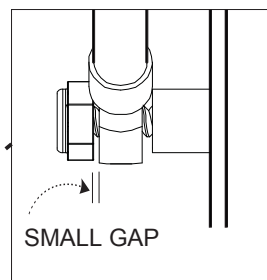
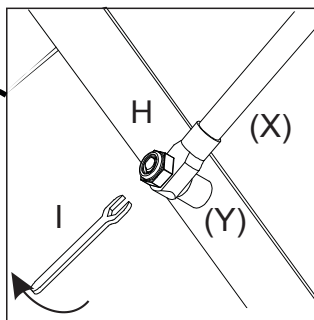

Stage

10

Push x2 Mattress Stoppers (8) into metal frame, they should go all the way through the upper & lower metal sections.

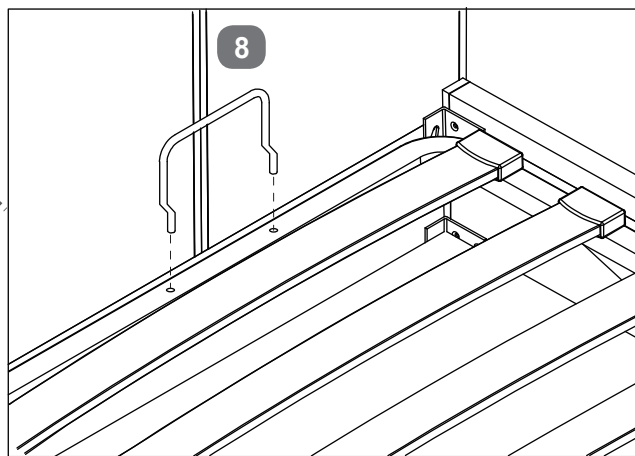
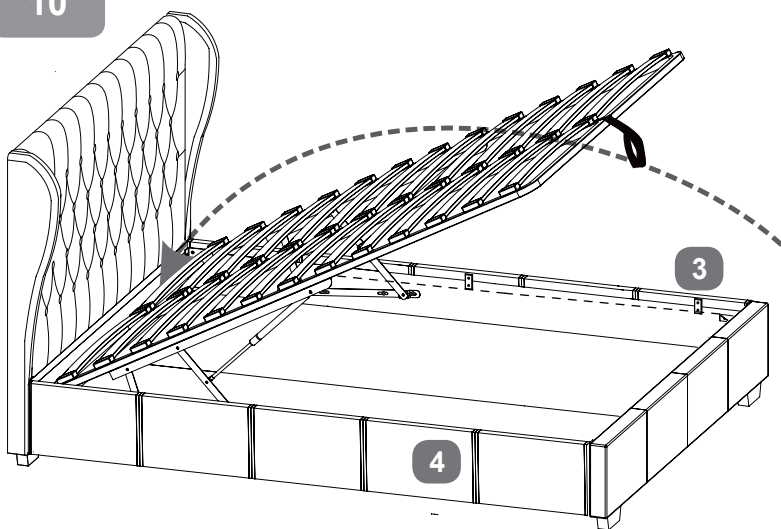

Note: Before fitting the mattress, carefully move slat frame up and down against the piston pressure making sure it slides easily. It is better that two people do this making sure all the mechanism is free. Note that it shall be stiff to start with. Place frame in the lower position then place mattress on top of the slats. Depending on the weight of the mattress, the speed of the lift will vary when lifting or lowering so be careful until you get used to the relevant speed with your own weight of mattress. Always use the fabric handle to lift or lower the frame - keep fingers well away from the moving parts.