

Reign Bed

Sprung slats

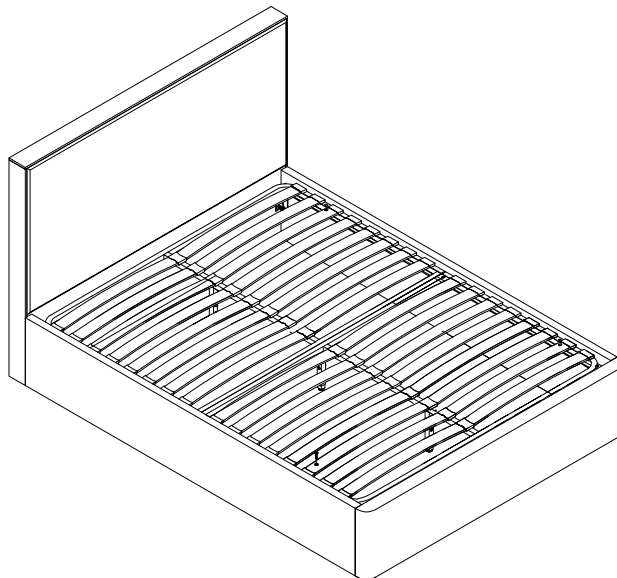

Sleepmotion

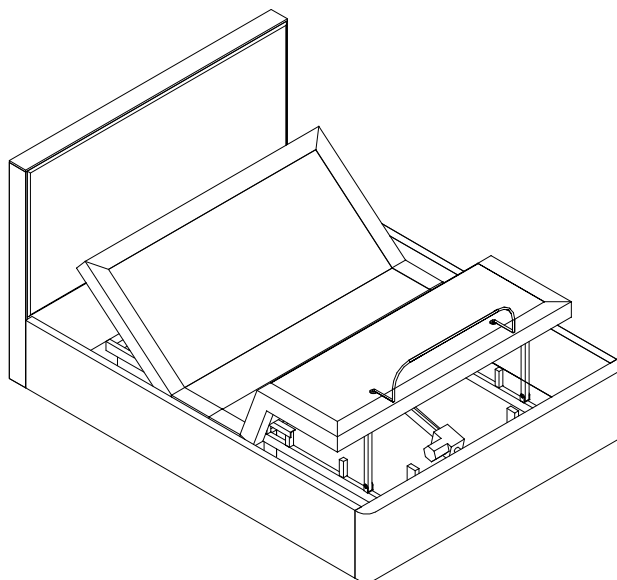

1 hour approx
assembly time



Two person
assembly

TEMPUR[®]
Dreams

Thank you

Hello, thanks for choosing to purchase your bed from Dreams - you're now on your way to your best ever night's sleep. Before you begin building your bed, please take a moment to read through the instructions and make sure that you've got all the relevant parts listed on the following pages.



Assembly tips

Before you begin, it's best to identify all parts and fittings to build your bed. We advise laying these out on the floor to check you have everything, and familiarising yourself before building.



Top tip

We recommend that you build your new bed in the room you'd like it to be located - this will help prevent any risk of damage to your newly built bed whilst moving it.



Safety and care

It's really important to ensure children and animals are kept away from the assembly area, as there are small components used in this bed which could present a choking hazard. All plastic and wrapping materials should also be kept away from children and animals to prevent any risk of suffocation. To keep your little ones busy, there is a colouring page inside the back cover.



Help and support

At Dreams, it's our mission to give the whole nation a great night's sleep - this means that the quality of our products is of utmost importance to us. If there are any issues with your product or any missing parts, please visit our website at www.dreams.co.uk/help



Recycling

Please ensure that packaging is disposed of in a safe and environmentally friendly way, and recycle where possible. Our assembly instructions are printed on recycled paper. Please keep your assembly instructions safe to refer back to in the future.

Parts

Important information

Please identify which base you have purchased with your bed frame as the assembly method may change. Once you have identified you have all of the relevant parts and fittings, please follow the instructions for your chosen base below;

Sprung slats Page 5、6

Sleepmotion Page 7、8、9、10

Sprung slats

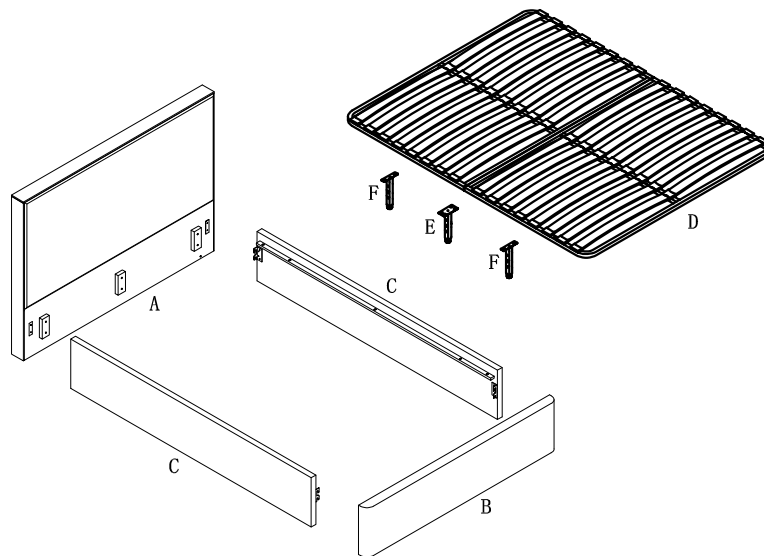

Sleepmotion

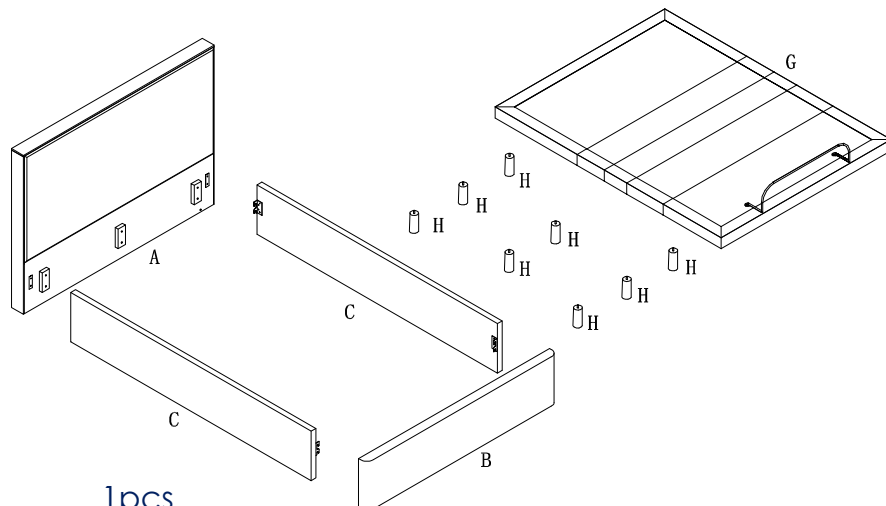

Parts list

A.	Headboard	1pcs
B.	Footboard	1pcs
C.	Side rails(Left & right)	2pcs
D.	Sprung slats	1pcs
E.	Support leg 1	1pcs
F.	Support leg 2	2pcs
G.	Sleepmotion	1pcs
H.	Legs	8pcs

Fittings

Please check you have all the parts listed below with your product:

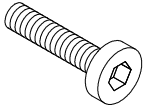

H1. M6x35mm x6pcs

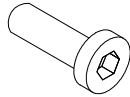

H2. M6x30mm x6pcs



H3. Metal Washer x6pcs

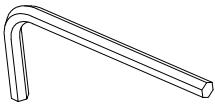

H4. 4mm Allen key x2pcs

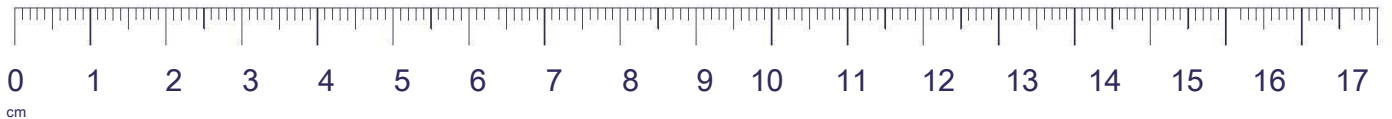

Tools required

Please check you have all these below:



Scissors



Tape measure



Cross head screwdriver

Sprung slat assembly

1

(1).Attach the side rail(C)to the headboard(A)locating the brackets behind the flat washers.Loosley screw in the bolts but do not tighten them 100% yet.

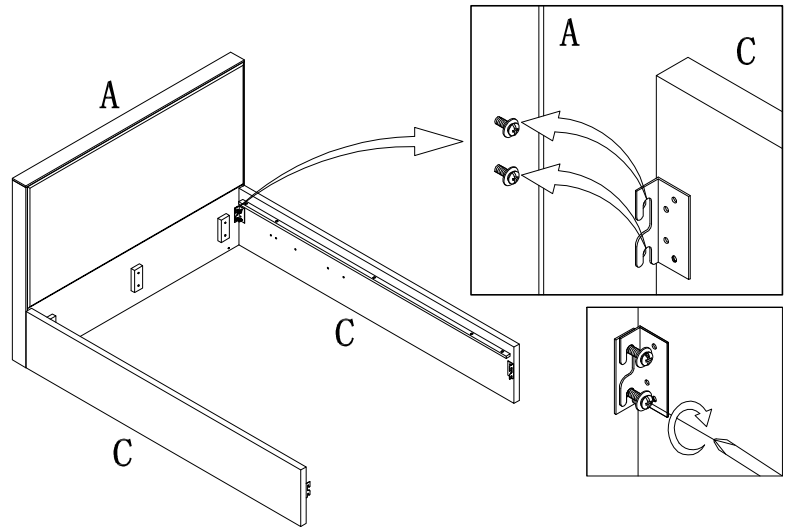

2

(1).Attach the footboard in the same way as the headboard.

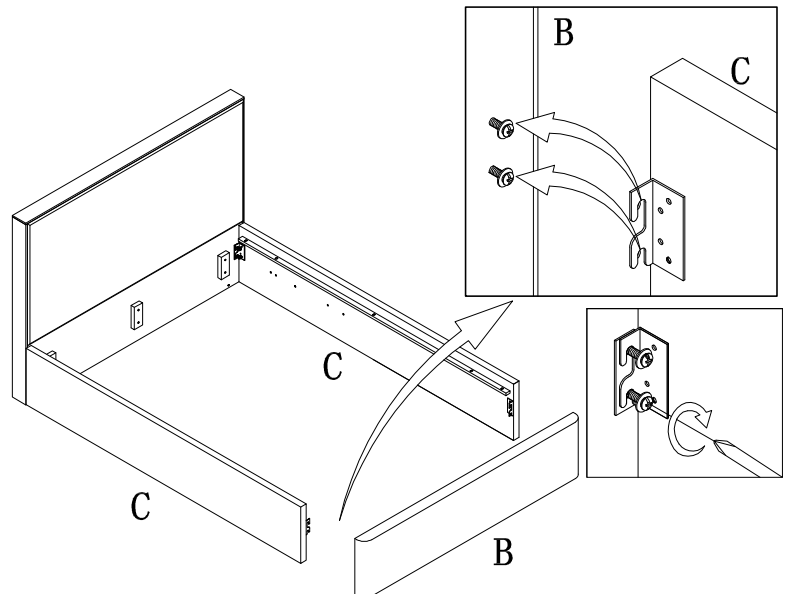

3

(1).Make certain the bed is squared up as shown in the diagram then fully tighten all the bolts.

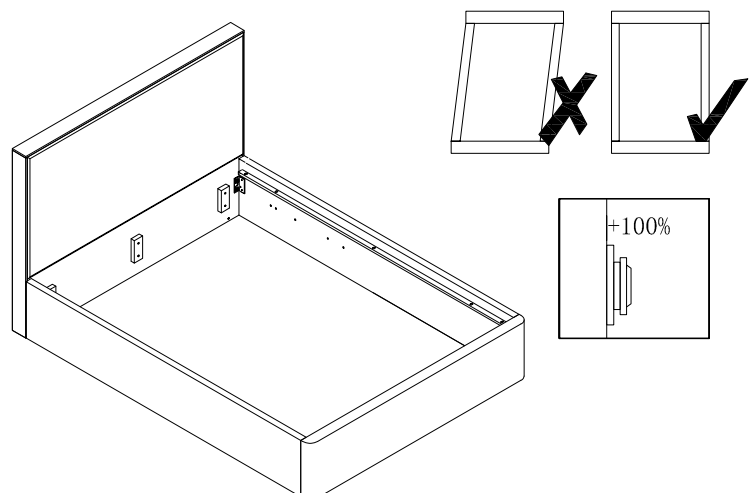

Sprung slat assembly

4

(1) Use the bolt to fix support leg onto The slat frame. Please note that these bolts are to be found inside the slat frame box. Carefully locate the slats onto the unit.

(2) Use bolt (M6x35mm) and jcn nut (M6x30mm) to fix the unit using 4mm allen key.

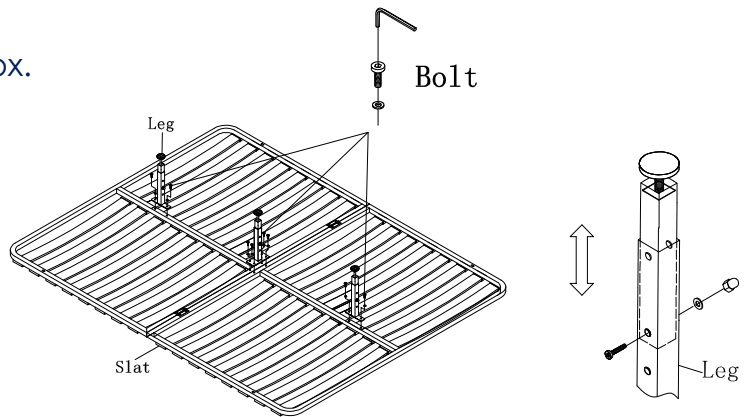

H1.M6×35mm x4pcs



H2.M6×30mm x4pcs



H3.Metal Washer x4pcs



H4.4mm Allen key x2pcs

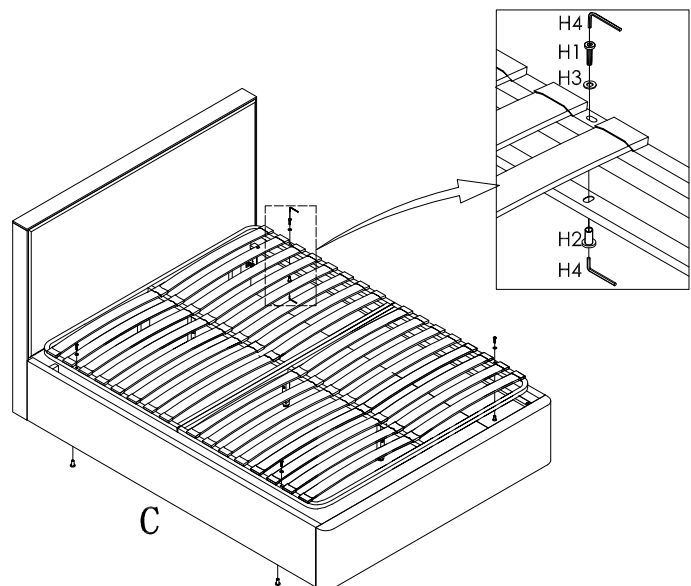

Sleepmotion assembly

Please ensure you have built your sleepmotion base first (please refer to instructions in your sleepmotion box to build the base). Please construct your sleep motion with the 15cm leg and then follow the below instructions to build the bed frame.

1

(1).Screw in the legs and put bed base in the position inwhich it will be used.

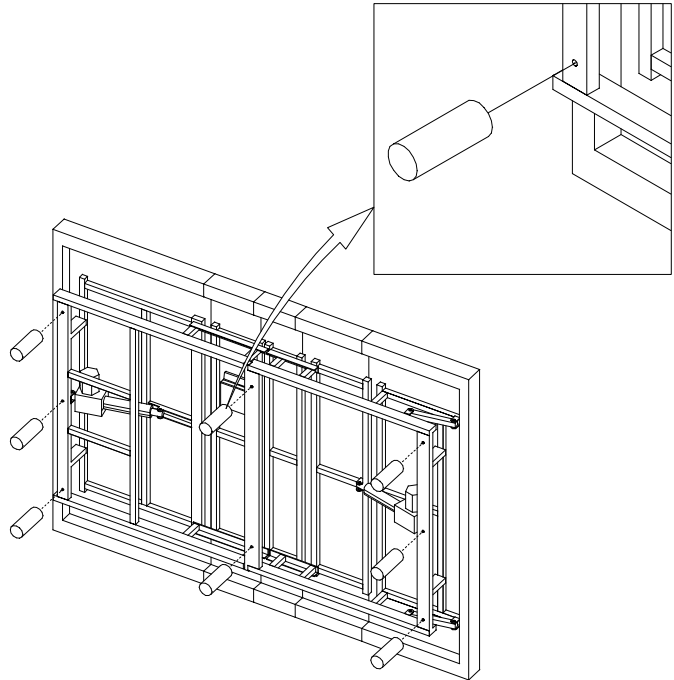

2

(1).Attach the side rail(C)to the headboard(A)locating the brackets behind the flat washers.Loosley screw in the bolts but do not tighten them 100% yet.

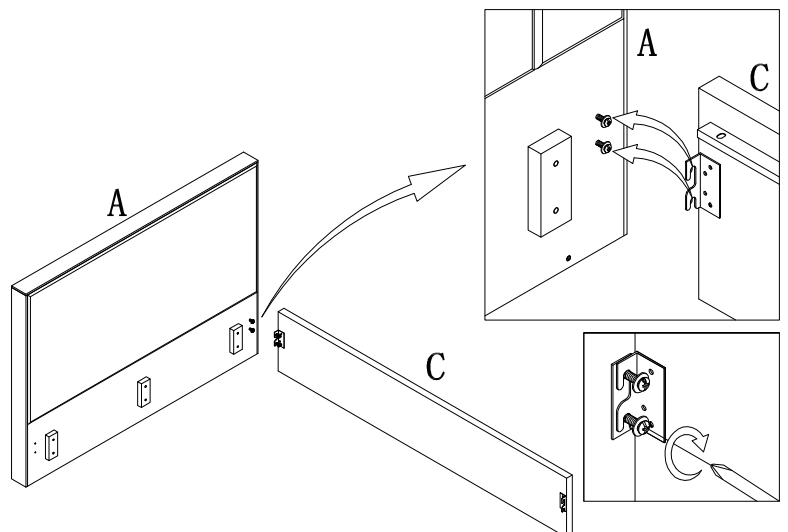

Sleepmotion assembly

3

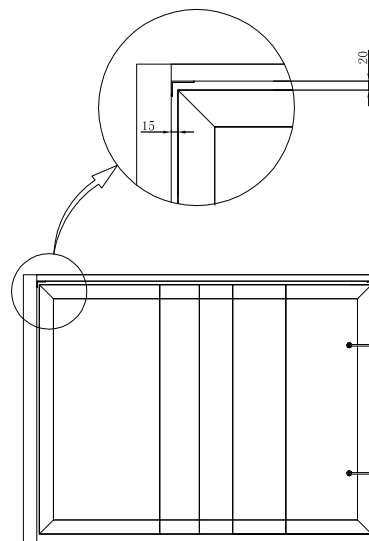
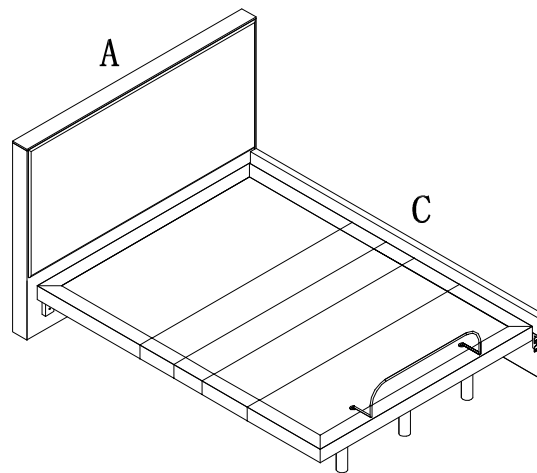

Sleepmotion assembly

4

(1).Raise the head and foot ends of the bed base.

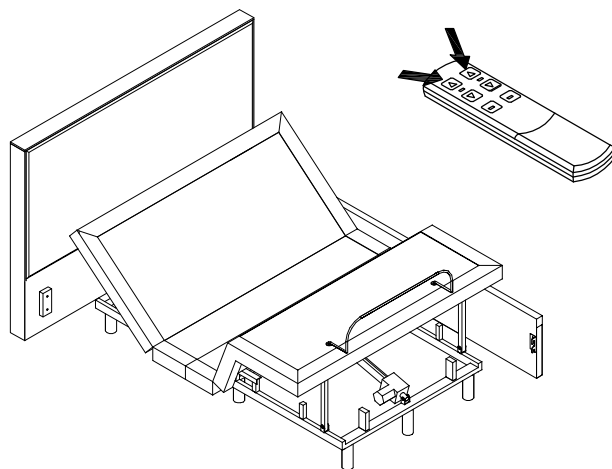
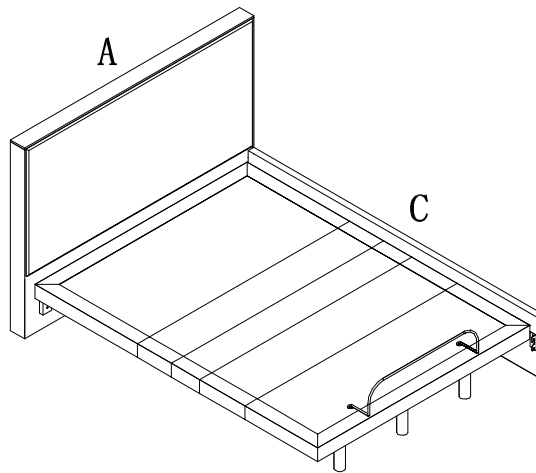

Sleepmotion assembly

5

- (1).Position foot end and connect side rail brackets.
- (2).Make sure everything is working properly then fit second side rail.
- (3).Install the footboard in the same way as the headboard.
- (4).Loosely screw in the bolts but do not tighten them 100% yet.

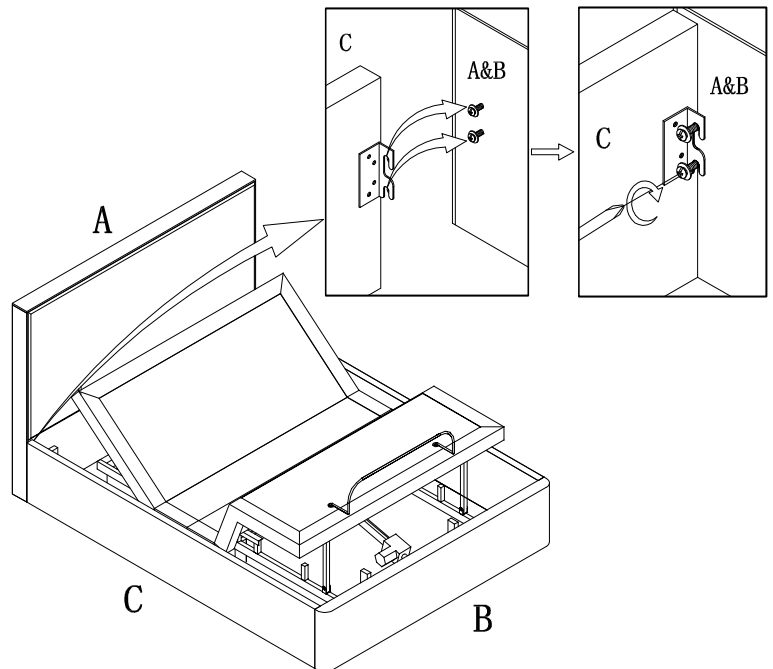

6

- (1).Make certain the bed is squared up as shown in the diagram then fully tighten all the bolts.

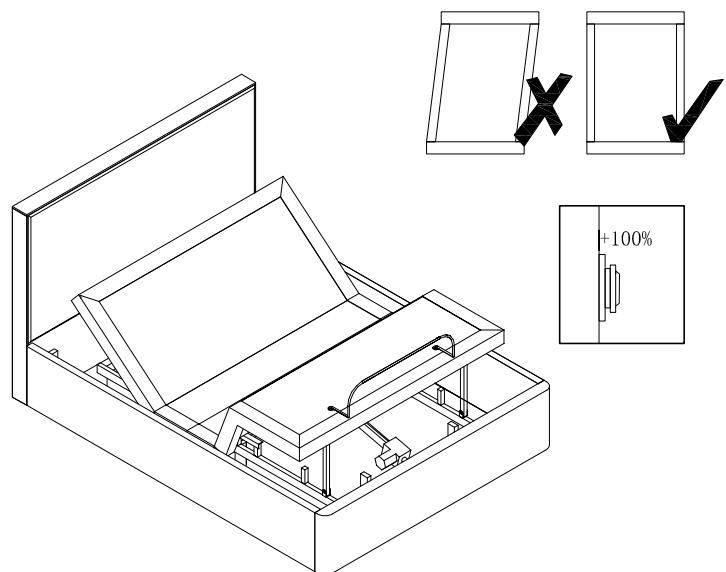

Care and maintenance

Here are some tips to keep your new bed in tip-top condition



Cleaning

To clean your new bed, we'd advise using a warm damp cloth - please do not use abrasive chemicals or bleach as this may damage the product.



Checking and moving

Periodically we recommend you check that the screws or fixtures haven't become loose, over time. To move your new bed, we recommend lifting it where possible, as dragging or pushing it could cause damage to your flooring.



Wood

Please note each of our wooden pieces are unique, meaning that markings and shade can vary slightly between beds. Over a period of time, the wood might lighten or fade slightly due to light exposure.



Fabric

Please note depending on the lighting, positioning and surroundings of your room, the colour of the fabric can sometimes appear slightly different. Over a period of time, the colour might lighten or fade slightly due to light exposure.



Metal

Metal tends to be more resilient to everyday wear and tear. We recommend to gently dust your metal furniture and keep it dry to maintain its look.

Thank you for shopping with us - we hope you have a great night's sleep

Sleep well



Little dreamers

Keep the little ones entertained while you assemble your new purchase.



