

Limerick Corner Sofa Bed

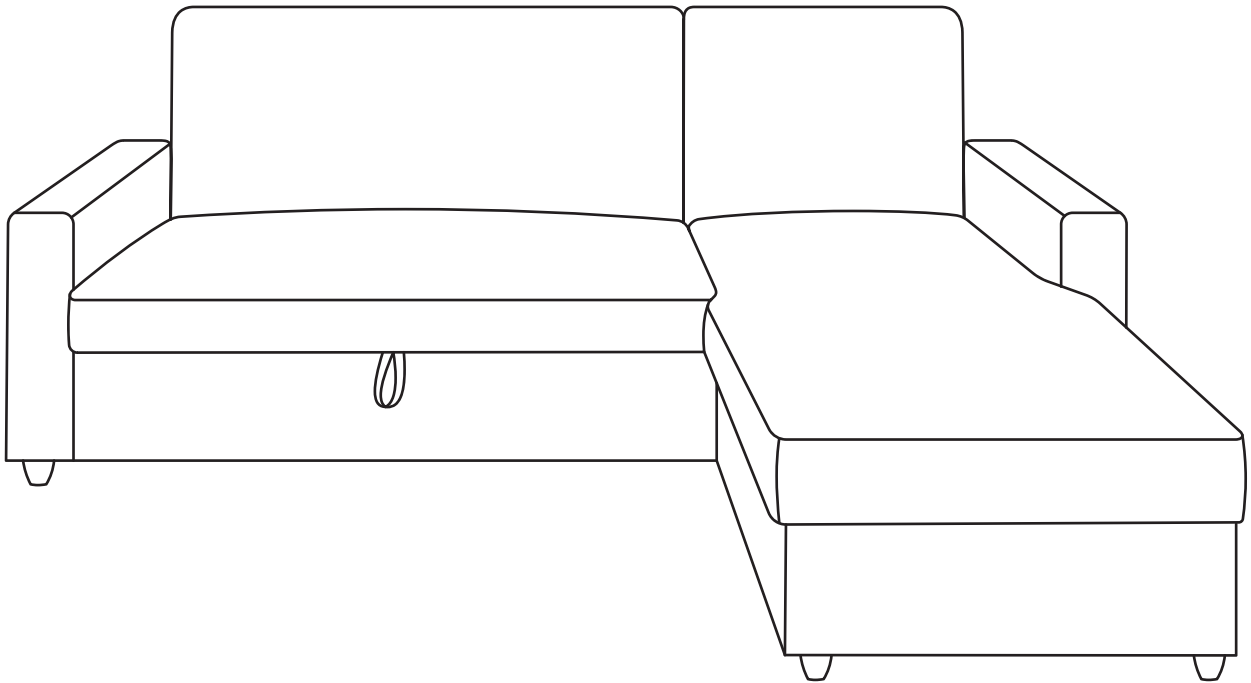

1 hour approx
assembly time



Two person
assembly

Dreams

Thank you

Hello, thanks for choosing to purchase your sofa bed from Dreams - you're now on your way to creating a practical and stylish solution for your room. Before you begin building your sofa bed, please take a moment to read through the instructions and make sure that you've got all the relevant parts listed on the following pages.



Assembly tips

Before you begin, it's best to identify all parts and fittings to build your sofa bed. We advise laying these out on the floor to check you have everything, and familiarising yourself before building.



Top tip

We recommend that you build your new sofa bed in the room you'd like it to be located - this will help prevent any risk of damage to your newly built sofa bed whilst moving it.



Safety and care

It's really important to ensure children and animals are kept away from the assembly area, as there are small components used in this bed which could present a choking hazard. All plastic and wrapping materials should also be kept away from children and animals to prevent any risk of suffocation. To keep your little ones busy, there is a colouring page inside the back cover.



Help and support

At Dreams, it's our mission to give the whole nation a great night's sleep - this means that the quality of our products is of utmost importance to us. If there are any issues with your product or any missing parts, please visit our website at www.dreams.co.uk/help



Recycling

Please ensure that packaging is disposed of in a safe and environmentally friendly way, and recycle where possible. Our assembly instructions are printed on recycled paper. Please keep your assembly instructions safe to refer back to in the future.

Parts

Important information

Once you have identified you have all of the relevant parts and fittings, please follow the instructions for your chosen sofa bed below:

Legs and Castor
Parts

Page 5
Page 6

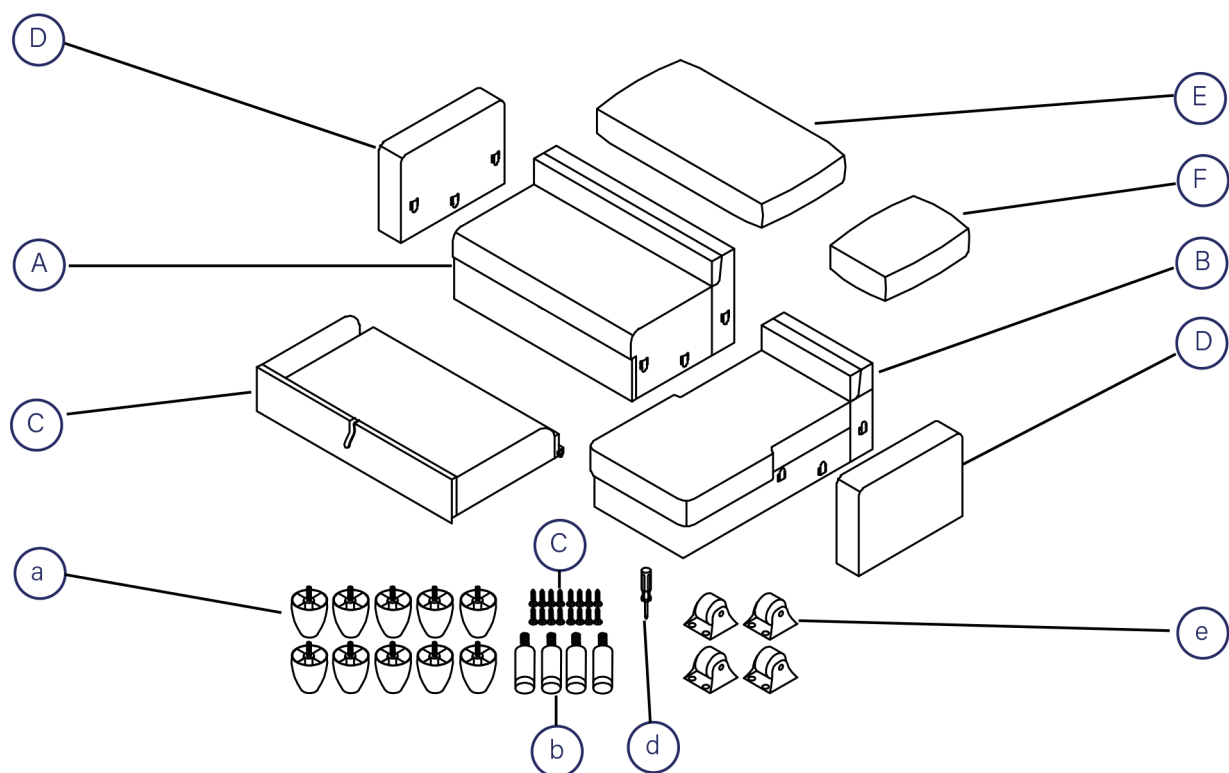

Parts list

A.	Two Seater Section	<input type="checkbox"/>	a.	Legs	<input type="checkbox"/>
B.	Chaise Section	<input type="checkbox"/>	b.	Support Leg	<input type="checkbox"/>
C.	Drawer	<input type="checkbox"/>	c.	Castor	<input type="checkbox"/>
D.	Arm Rest	<input type="checkbox"/>	d.	Screw	<input type="checkbox"/>
E.	Short Back Cushion	<input type="checkbox"/>	e.	Screw driver	<input type="checkbox"/>
F.	Long Back Cushion	<input type="checkbox"/>			

Fittings

Please check you have all the parts listed below with your product:



Screw (5*25mm)

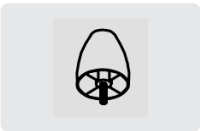

Legs (70*60mm)



Support Leg
(25*55mm)



Castor (40*60mm)



Tools required

Please check you have all these below:



Flathead
screwdriver

Leg Assembly

Use Pack 'X'

1

Unpack your sofa bed and check you have all the necessary items (see page 3).

Place the sofa bed face down on a clean, flat surface.

Attach the legs as shown in the diagram to the right.

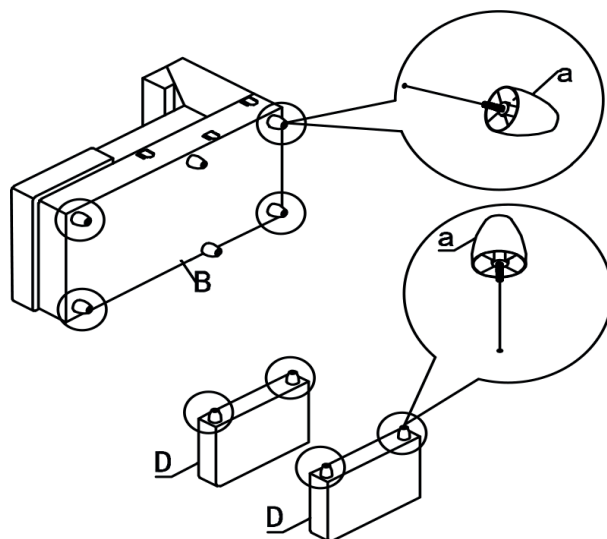

2

Affix the support leg and castors as shown in the diagram to the right, using the screws and screw driver supplied.

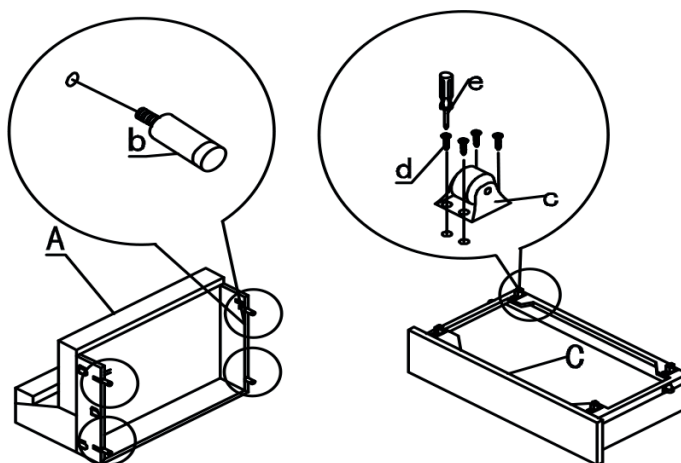

3

Lift section 2 over retainer on section 1, and push section 2 underneath.

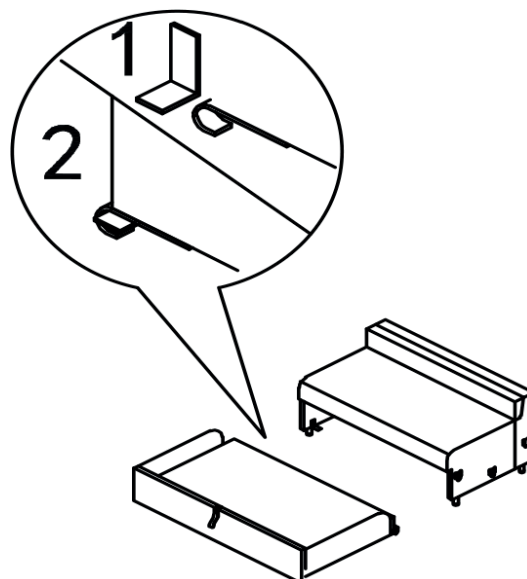

Parts assembly

Use Pack 'X'

4

To put the sofa bed together, first choose whether the chaise should be on the left or right hand side.

Align the chaise and two seater section of the sofa bed.

The section with the downward facing brackets should be lifted up so that the male and female brackets line up.

Push down firmly so the brackets connect.

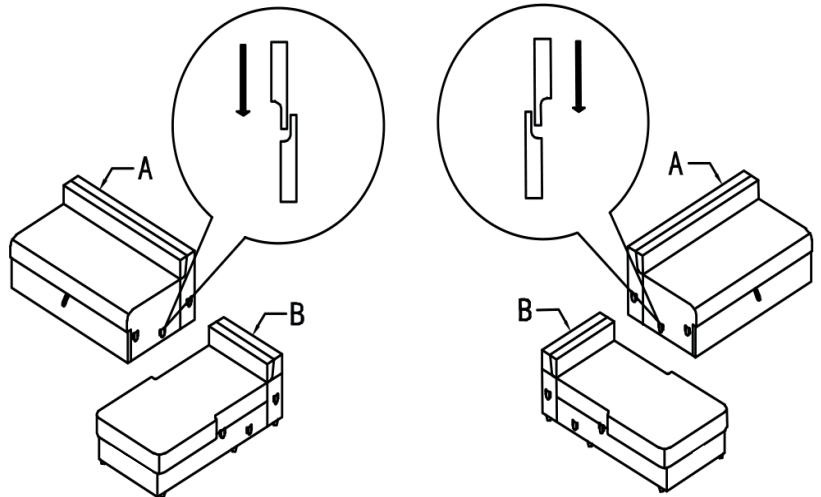

5

The arms can then be secured on the ends of the sofa bed. The arm with the downward facing brackets should be aligned with the end of the chaise/2 seater section with upward facing brackets and then pushed down firmly to connect.

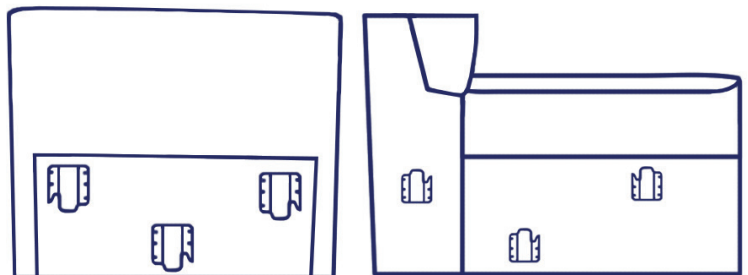

6

The arm with the upward facing brackets should be aligned with the other end of the sofa bed. The section with downward facing brackets should then be lifted carefully so that it aligns with the brackets on the arm. Once the brackets are aligned, push down firmly on the sofa bed section so that the brackets connect.

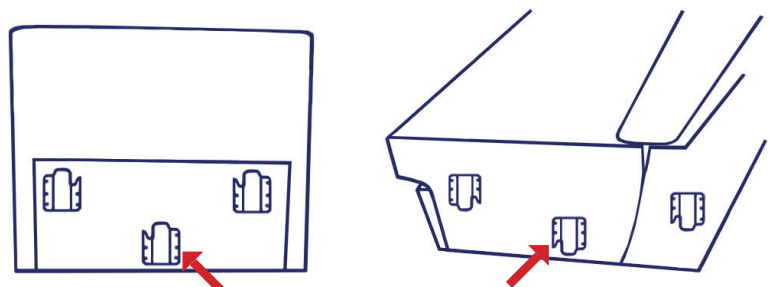

Lift end section, align with brackets on arms and push down firmly.

Operating Instructions

To operate the pop-up bed section of the sofa bed, grasp the strap and pull the drawer out carefully until it is fully extended. Once the drawer is fully open, place one hand on top of the pop-up section and grasp the strap with the other hand. Pull upwards and then outwards on the strap, keeping the other hand on top of the pop-up section to ensure a smooth motion, until the pop-up section of the sofa bed is in place.

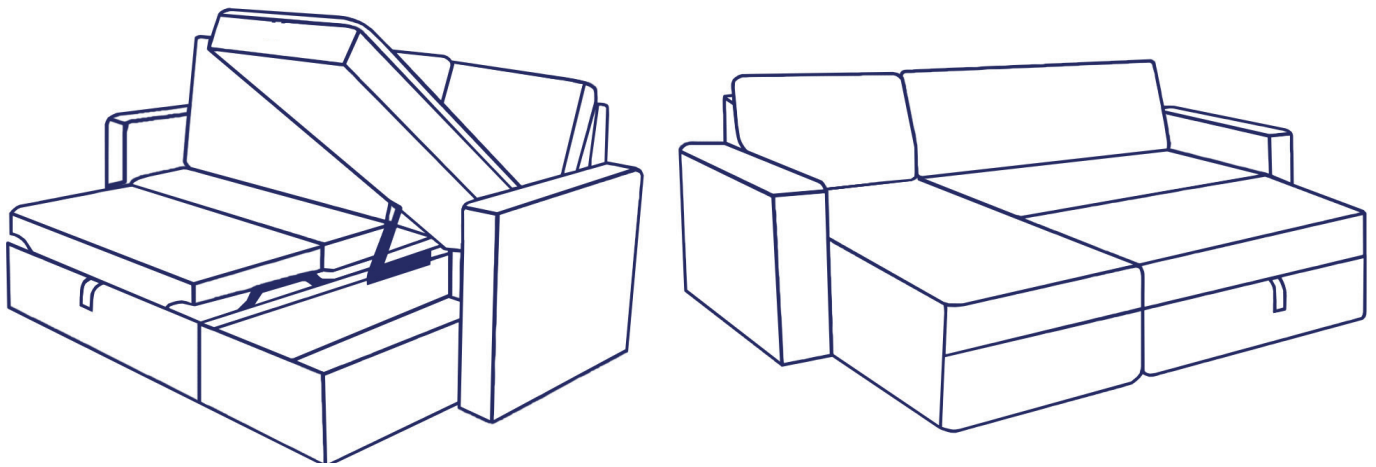

To collapse the pop-up section, grasp the strap firmly in one hand and place the other hand on top of the drawer. Pull the strap upwards and use the other hand to guide the pop-up section gently back into the drawer. Push the drawer back into the closed position.

WARNING: PULLING TOO HARD OR FAST ON THE STRAP MAY CAUSE DAMAGE TO THE MECHANISM. TAKE CARE NOT TO TRAP FINGERS OR HANDS DURING THE OPERATING OF THIS PRODUCT. DO NOT ALLOW CHILDREN TO PLAY WITH OR RETRACT THE MECHANISM.

Operating Instructions

To operate the storage section of the sofa bed, grasp the strap firmly with one hand and place the other hand on top of the chaise seat cushion. Pull the strap firmly upwards, keeping the other hand in place to ensure a smooth motion.

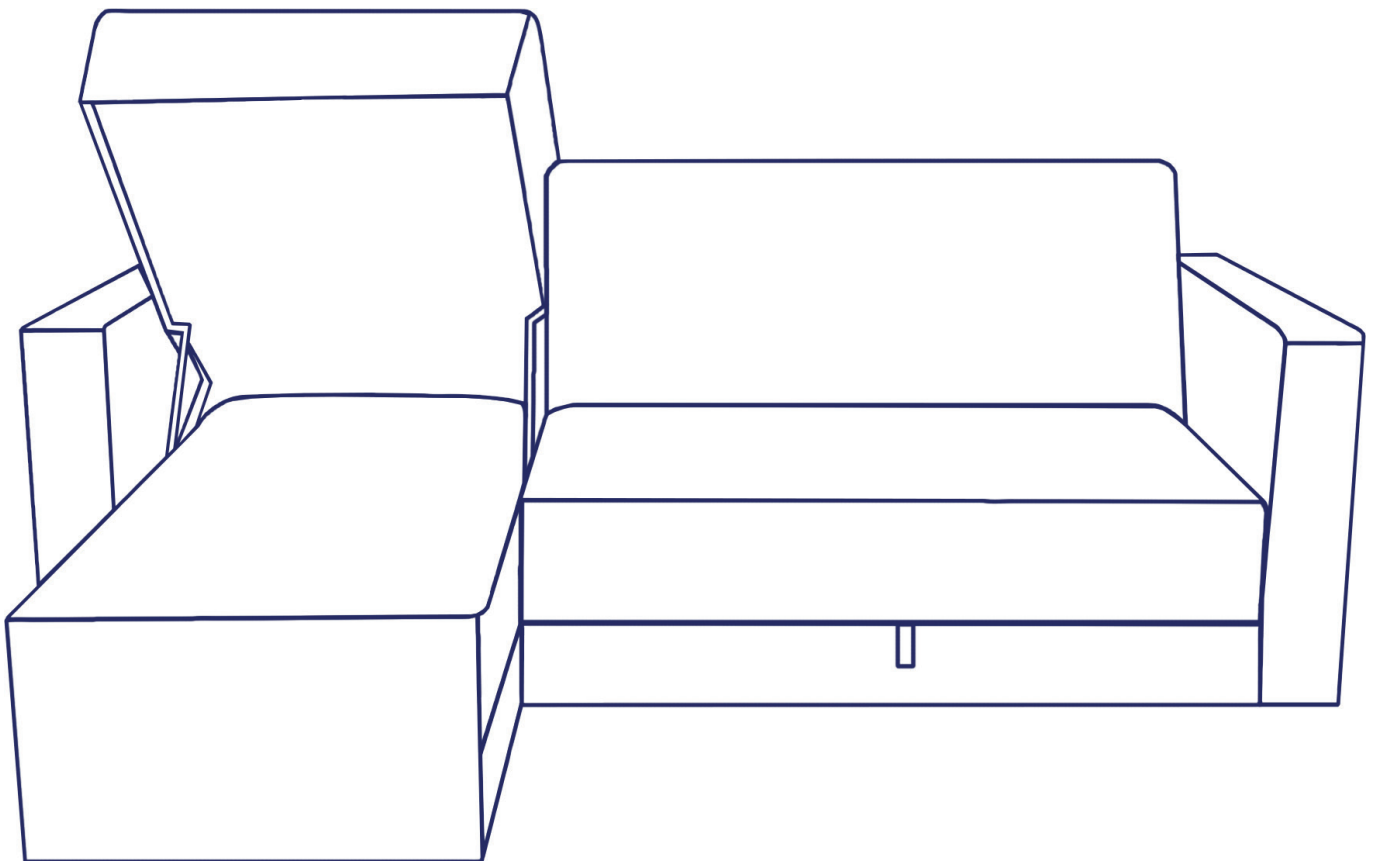

To close the storage section, grasp the strap firmly in one hand and place the other on top of the chaise section. Pull down gently on the strap, using the other hand to push down on the chaise and close the storage section.

WARNING: PULLING TOO HARD OR FAST ON THE STRAP MAY CAUSE DAMAGE TO THE MECHANISM. TAKE CARE NOT TO TRAP FINGERS OR HANDS DURING THE OPERATING OF THIS PRODUCT. DO NOT ALLOW CHILDREN TO PLAY WITH OR RETRACT THE MECHANISM.

Care and maintenance

Here are some tips to keep your new sofa bed in tip-top condition



Cleaning

To clean your new sofa bed, we'd advise using a warm damp cloth - please do not use abrasive chemicals or bleach as this may damage the product.



Checking and moving

Periodically we recommend you check that the screws or fixtures haven't been become loose, over time. To move your new sofa bed, we recommend lifting it where possible, as dragging or pushing it could cause damage to your flooring.



Wood

Please note each of our wooden pieces are unique, meaning that markings and shade can vary slightly between sofa beds. Over a period of time, the wood might lighten or fade slightly due to light exposure.



Fabric

Please note depending on the lighting, positioning and surroundings of your room, the shade of the colour can sometimes appear slightly different. Over a period of time, the colour might lighten or fade slightly due to light exposure.



Metal

Metal tends to be more resilient to everyday wear and tear. We recommend to gently dust your metal furniture and keep it dry to maintain its look.

Thank you for shopping with us - we hope you have a great night's sleep

Sleep well



Little dreamers

Keep the little ones entertained while you assemble your new purchase.



Dreams