

# Rainbow Single Bed

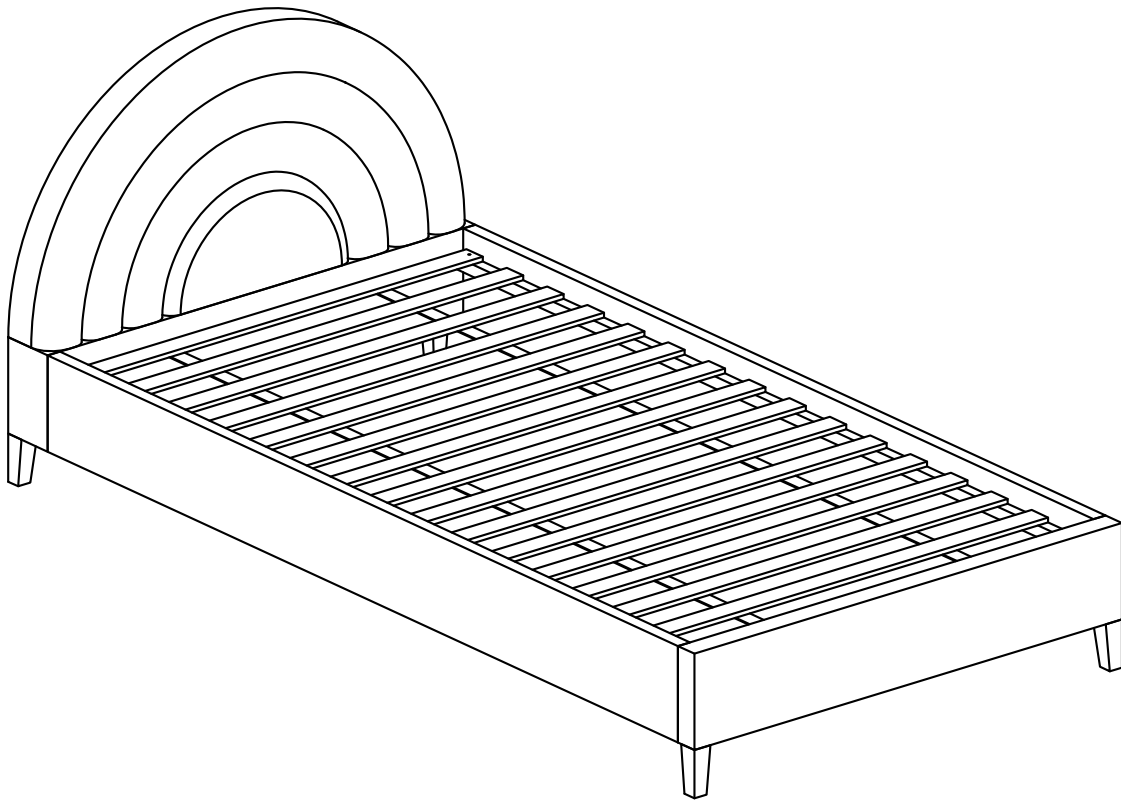

1 hour approx  
assembly time



Two person  
assembly

**Dreams**

# Thank you

Hello, thanks for choosing to purchase your bed from Dreams - you're now on your way to your best ever night's sleep. Before you begin building your bed, please take a moment to read through the instructions and make sure that you've got all the relevant parts listed on the following pages.



## Assembly tips

Before you begin, it's best to identify all parts and fittings to build your bed. We advise laying these out on the floor to check you have everything, and familiarising yourself before building.



## Top tip

We recommend that you build your new bed in the room you'd like it to be located - this will help prevent any risk of damage to your newly built bed whilst moving it.



## Safety and care

It's really important to ensure children and animals are kept away from the assembly area, as there are small components used in this bed which could present a choking hazard. All plastic and wrapping materials should also be kept away from children and animals to prevent any risk of suffocation. To keep your little ones busy, there is a colouring page inside the back cover.



## Help and support

At Dreams, it's our mission to give the whole nation a great night's sleep – this means that the quality of our products is of utmost importance to us. If there are any issues with your product or any missing parts, please visit our website at [www.dreams.co.uk/help](http://www.dreams.co.uk/help)



## Recycling

Please ensure that packaging is disposed of in a safe and environmentally friendly way, and recycle where possible. Our assembly instructions are printed on recycled paper. Please keep your assembly instructions safe to refer back to in the future.

# IMPORTANT!

## KEEP FOR FUTURE REFERENCE

**WARNING.** Do not place this child's bed near heat sources, windows, and other furniture.

**WARNING.** Do not use this child's bed if any part is broken, torn or missing.

**WARNING.** Not suitable for children under 4 years.

### Care and Maintenance of your Furniture

- Please periodically check all fittings and re-tighten as necessary.
- To clean your item, wipe with a cloth slightly dampened with water. Then buff with a dry clean cloth.
- Routinely check that the fittings are secure and tighten any fittings using the appropriate tools.
- The child's bed conforms to BS8509: 2008 + A1:2011 standards.
- This child's bed is intended for children above 4 years old.
- The age range of the child bed is 4 - 10 years old.
- The size of the mattress to be used with the child's bed is 900mm x 1900mm.
- This child's bed should not be placed too close to other furniture or windows and should be placed either tight against a wall or have a gap of 300mm between the wall and side of the bed.
- Periodically check the condition of your bed slats and plastic locating caps to ensure they are in good condition and not become loose.
- When moving your assembled bed it is best to remove the mattress and bedding and lift the bed, never drag the frame.
- Never allow any kind of liquid to remain on your furniture. Absorption can cause finishes to delaminate.

**WARNING!** Do not place this bed near direct heat sources.

**WARNING!** Do not use this bed if any part is broken, torn or missing.

**WARNING!** Assembly by adult only.

**WARNING!** Once assembled this bed is not designed to be disassembled and reassembled.

# Parts

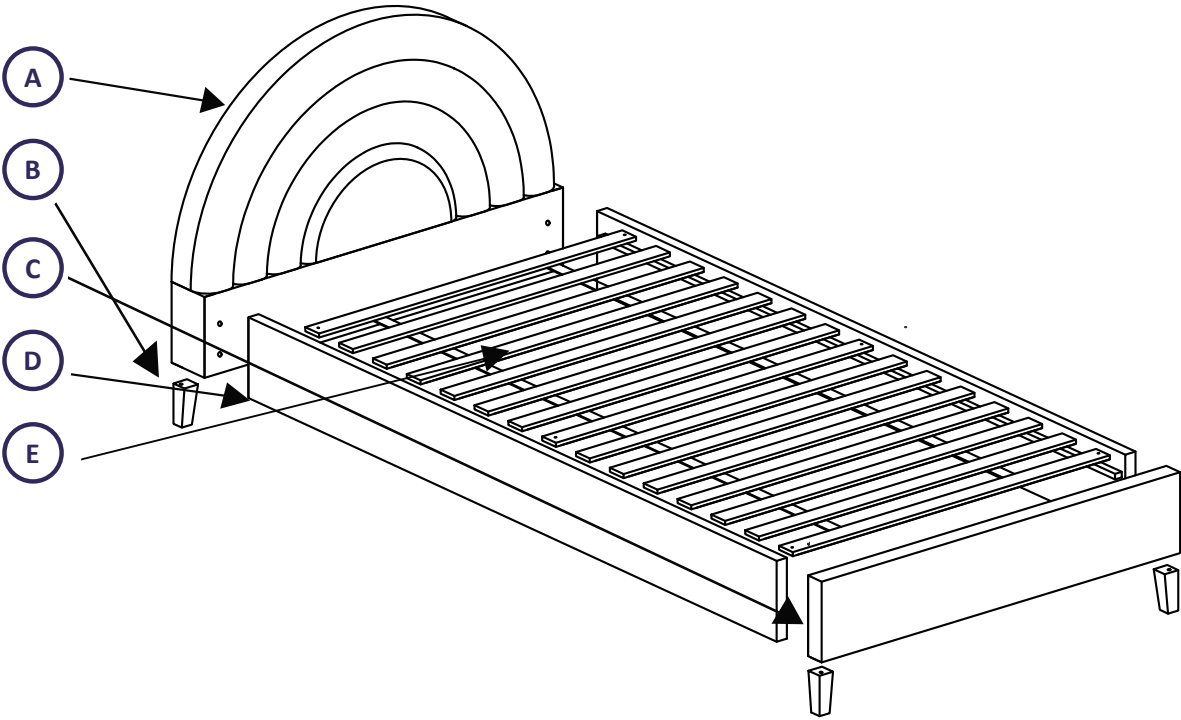

## Parts list

A.	HEADBOARD	QTY	1
B.	WOODEN FEET	QTY	4
C.	FOOTBOARD	QTY	1
D.	SIDE RAILS	QTY	2
E.	SLATS	QTY	1

# Fittings

Please check you have all the parts listed below with your product:

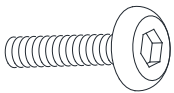

H1: M8 x 30mm  
Qty: x8



H2: M6 x 50mm  
Qty: x6

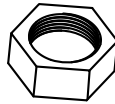

H3: M6 Nut  
Qty: x6



H4: M8 Flat Washer  
Qty: x8



H5: M8 Allen key  
Qty: x1



H6: M6 Allen key  
Qty: x1



H7: Spring Washer  
Qty: x8



H8: M6 Flat Washer  
Qty: x6



H9: M6 Spanner  
Qty: x1

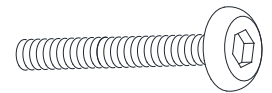

H10 : M8 x 50mm  
Qty: x4

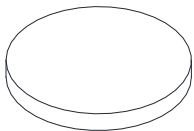

H11 : 1 x35 mm  
Qty: x4

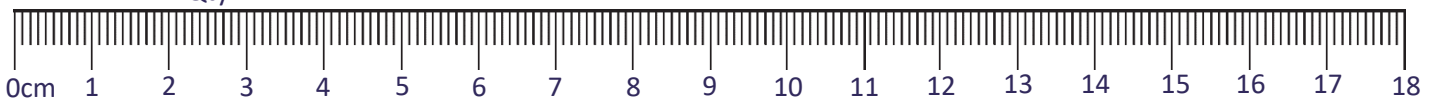

# Tools required

Please check you have all these below:



Flathead  
screwdriver



Scissors



Spanner



Tape measure



Cross head  
screwdriver

# Bed assembly

1

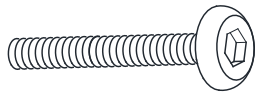

H10 : M8 x 50mm  
Qty: x4



H5: M8 Allen key  
Qty: x1

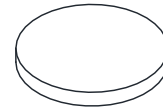

H11 : 1 x 35 mm  
Qty: x4

Attach the Wooden Feet (B) to the Headboard (A) and Footboard (C) by using Bolt (H10) with Allen key M8(H5)

After attach the Wooden Feet, Place wool felt pads(H11) on the bottom of the wooden legs to cover the round holes

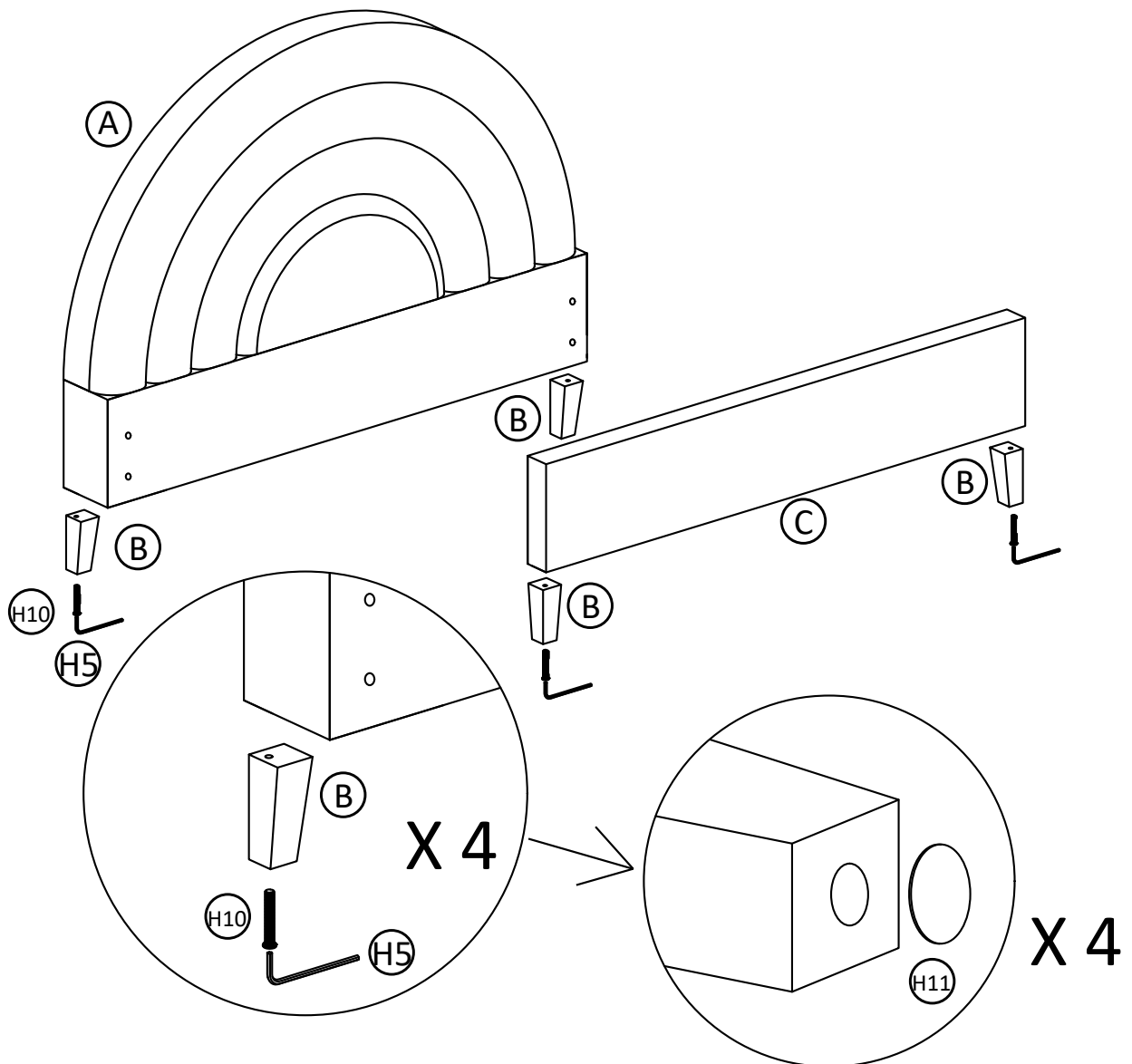

# Bed assembly

2

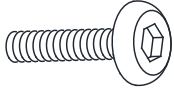

H1: M8 x 30mm  
Qty: x8



H4: M8 Flat Washer  
Qty: x8

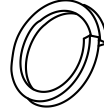

H7: Spring Washer  
Qty: x8



H5: M8 Allen key  
Qty: x1

Use Bolt (H1), Spring washer (H7) and Flat washer (H4) to fix the Side Rail ( D ) onto Headboard ( A ) and Footboard ( C ) by using Allen Key ( H5 ).

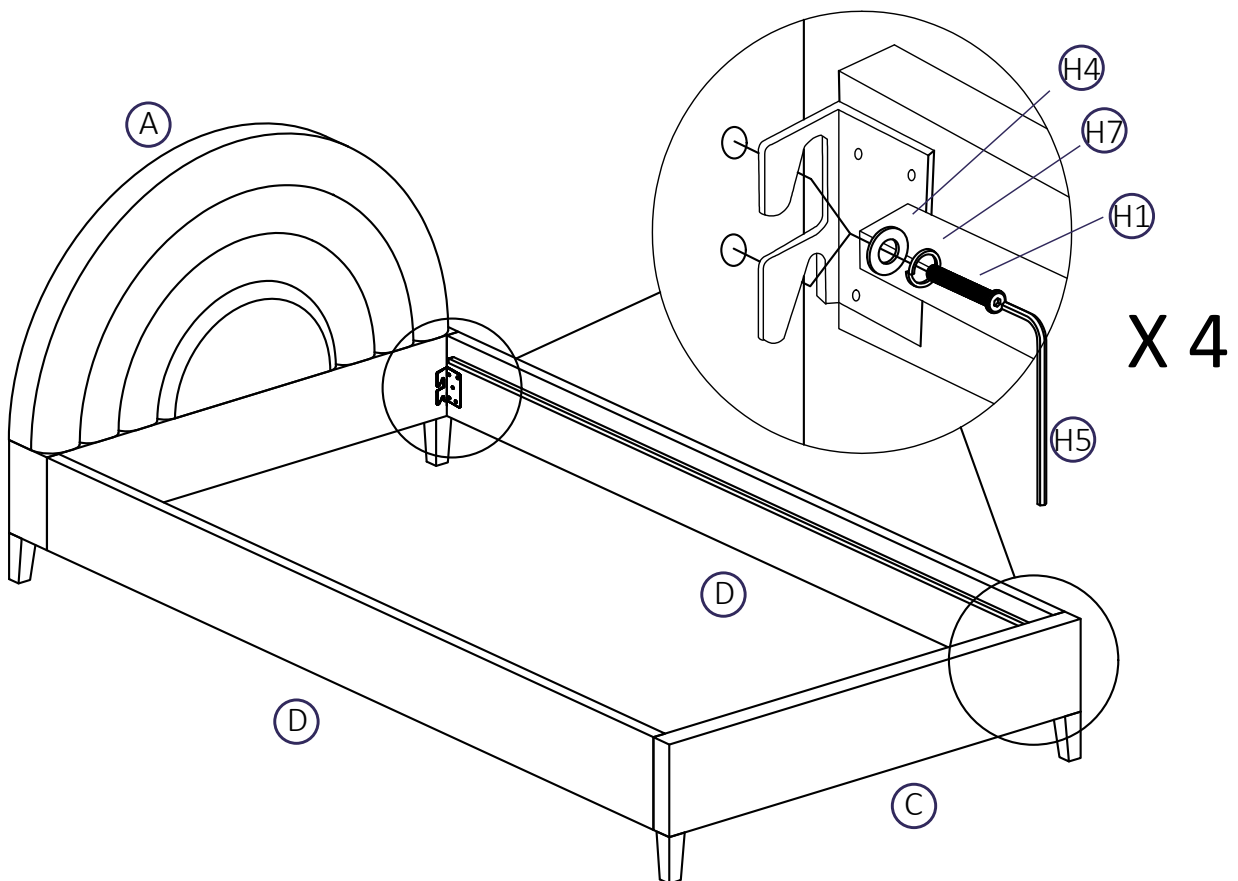

# Bed assembly

3



H6: M6 Allen key  
Qty: x1



H2: M6 x 50mm  
Qty: x6



H8: M6 Flat Washer  
Qty: x6

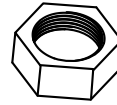

H3: M6 Nut  
Qty: x6



H9: M6 Spanner  
Qty: x1

Carefully locate the slats(E) onto the unit. Use Bolt (H2), Flat Washer (H8) and M6 Nut (H3) to fix the unit using Allen Key (H6) and Spanner Key (H9).

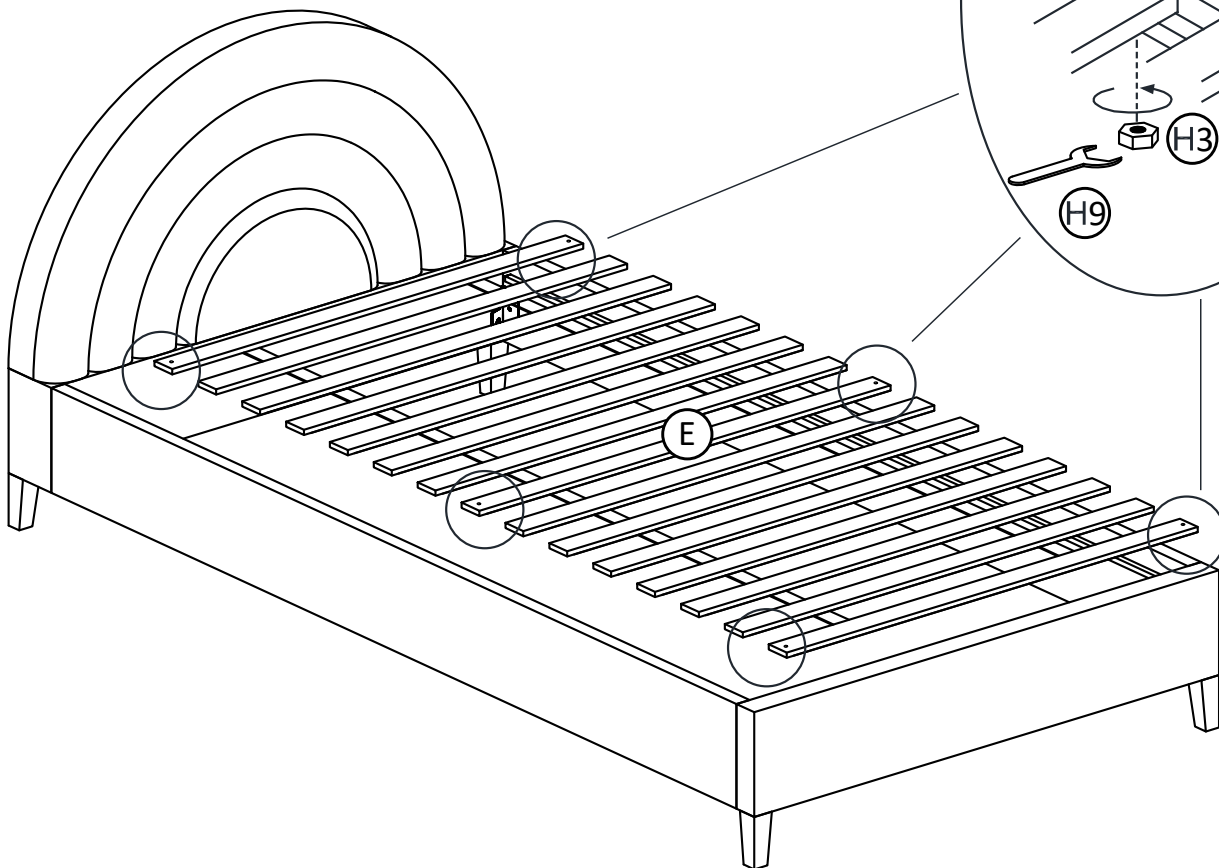



# Care and maintenance

Here are some tips to keep your new bed in tip-top condition



## Cleaning

To clean your new bed, we'd advise using a warm damp cloth - please do not use abrasive chemicals or bleach as this may damage the product.



## Checking and moving

Periodically we recommend you check that the screws or fixtures haven't been become loose, over time. To move your new bed, we recommend lifting it where possible, as dragging or pushing it could cause damage to your flooring.



## Wood

Please note each of our wooden pieces are unique, meaning that markings and shade can vary slightly between beds. Over a period of time, the wood might lighten or fade slightly due to light exposure.



## Fabric

Please note depending on the lighting, positioning and surroundings of your room, the shade of the colour can sometimes appear slightly different. Over a period of time, the colour might lighten or fade slightly due to light exposure.



## Metal

Metal tends to be more resilient to everyday wear and tear. We recommend to gently dust your metal furniture and keep it dry to maintain its look.

**Thank you for shopping with us - we hope you have a great night's sleep**

*Sleep well*



# Little dreamers

Keep the little ones entertained while you assemble your new purchase.



**Dreams**